



Fulham Road, Fulham SW6

£374,950

Leasehold

A new development offering a selection of one bedroom and studio apartments finished to a very good standard located close to the local amenities, restaurants and cafes on the Fulham Road.

- Studio Apartment
- Separate Sleeping Area
- Access to a Flat Roof
- Private Entrance
- Great Transport Links
- Close to Bishops Park
- Private Entrance
- EPC Rating C

London. Property. We get it.

Fulham

825-827 Fulham Road, Parsons Green, SW6 5HG,
020 3486 2280, fulhamroad.sales@kfh.co.uk



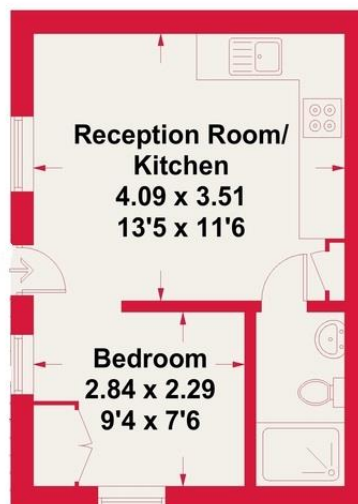

Raised Ground Floor

Fulham Road

Approximate Gross Internal Area = 270 sq ft / 25 sq m

Kinleigh Folkard & Hayward

Whilst every attempt has been made to ensure the accuracy of the floor plan contained here, measurements of doors, windows and rooms are approximate and no responsibility is taken for any error, omission or misstatement. These plans are for representation purposes only as defined by RICS Code of Measuring Practice and should be used as such by any prospective purchaser. Specifically no guarantee is given on the gross internal floor area of the property if quoted on this plan and any figure given is for initial guidance only and should not be relied on as a basis of valuation.

Tenure	Leasehold
Price	£374,950
Viewing	Strictly by appointment with Kinleigh Folkard & Hayward Fulham office Telephone 020 3486 2280
Reference	2220059

Whilst every effort is made to ensure the accuracy of these details, it should be noted that the above measurements are approximate only. Floorplans are for representation purposes only and prepared according to the RICS Code of Measuring Practice by our floorplan provider. Therefore, the layout of doors, windows and rooms are approximate and should be regarded as such by any prospective purchaser. Any internal photographs are intended as a guide only and it should not be assumed that any of the furniture/fittings are included in any sale. Where shown, details of lease, ground rent and service charge are provided by the vendor and their accuracy cannot be guaranteed, as the information may not have been verified and further checks should be made either through your solicitor/conveyance. Where appliances, including central heating, are mentioned, it cannot be assumed that they are in working order, as they have not been tested. Please also note that wiring, plumbing and drains have not been checked.