



**Hanbury Road, Acton, W3**

**Kinleigh Folkard & Hayward**







**Hanbury Road,  
Acton, W3**  
**£550,000**  
**Leasehold**

---

A stunning two bedroom purpose build flat offering 852 square feet of living space, stylish bathroom, fully fitted kitchen and larger than average balcony. There are well kept communal gardens and on street parking available. Viewing comes highly recommended.

- Two double bedrooms
- Large balcony
- Beautifully presented
- High security entrance
- Large communal gardens
- Ample storage throughout
- Acton Town Tube nearby
- EPC rating- B

---

**Positioned on the second floor of this attractive and imposing building, is this immaculate two double bedroom flat which is conveniently located nearby to Acton Town Tube Station.**

---

For more information or to arrange a viewing please contact:

**Acton**  
145 High Street  
Acton, W3 6LP  
020 8104 3650  
acton.sales@kfh.co.uk

---

**Kinleigh Folkard & Hayward**

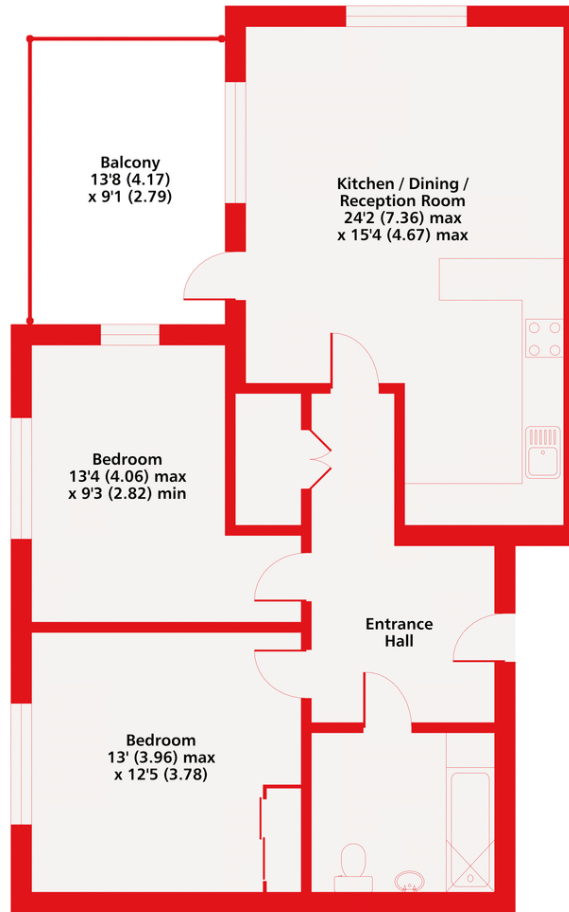

Second Floor

Hanbury Road W3  
 Approximate Area = 852 sq ft / 79.2 sq m  
 For identification only - Not to scale

Kinleigh Folkard & Hayward



Floor plan produced in accordance with RICS Property Measurement Standards incorporating International Property Measurement Standards (IPMS2 Residential). © nchecon 2020. Produced for Kinleigh Folkard & Hayward. REF: 639010

These particulars are believed to be correct but their accuracy is not guaranteed and they do not form part of any contract. Whilst every effort is made to ensure the accuracy of these details, it should be noted that the above measurements are approximate only. Floorplans are for representation purposes only and prepared according to the RICS Code of Measuring Practice by our floorplan provider. Therefore, the layout of doors, windows and rooms are approximate should be regarded as such by any prospective purchaser. Any internal photographs are intended as a guide only and it should not be assumed that any of the furniture/fittings are included in any sale. Where shown, details of lease, ground rent and service charge are provided by the vendor and their accuracy cannot be guaranteed, as the information may not have been verified and further checks should be made either through your solicitor/conveyancer or by referring to the home information pack for this property. Where appliances, including central heating, are mentioned, it cannot be assumed that they are in working order, as they have not been tested. Please also note that wiring, plumbing and drains have not been checked.

