



**Bowen Drive, Dulwich, SE21**

**Kinleigh Folkard & Hayward**







**Bowen Drive,  
Dulwich, SE21**  
**£270,000**  
**Leasehold**

Bowen Drive affords easy access to local shopping and leisure amenities whilst nearby Crystal Palace, West Norwood and Dulwich provide numerous restaurants, bars, cinemas and trendy shops and cafes.

- One double bedroom
- Spacious lounge
- Bright modern bathroom
- Seperate kitchen
- Private garden
- Close to station
- 523 sq ft approx
- EPC rating D

---

Located on the ground floor of this low rise building close to Sydenham Hill station is a superb one bedroom garden apartment which would make an ideal first time or investment purchase.

---

For more information or to arrange a viewing please contact:

**West Dulwich**  
113 Rosendale Road  
Dulwich, SE21 8EZ  
020 8761 0900  
westdulwich.sales@kfh.co.uk

---

**Kinleigh Folkard & Hayward**

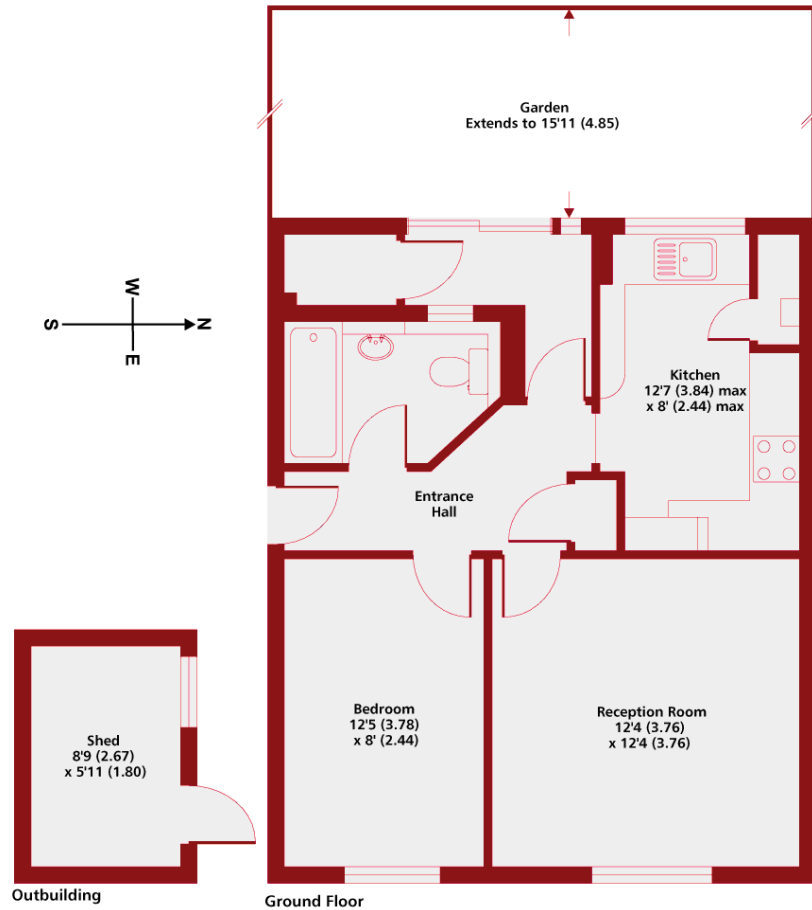

**Bowden Drive SE21**  
**Gross Internal Area 523 sq ft 48.5 sq metres (Excludes Outbuilding)**  
 Copyright nichecom.co.uk 2009 REF : 09-17248

These particulars are believed to be correct but their accuracy is not guaranteed and they do not form part of any contract. Whilst every effort is made to ensure the accuracy of these details, it should be noted that the above measurements are approximate only. Floorplans are for representation purposes only and prepared according to the RICS Code of Measuring Practice by our floorplan provider. Therefore, the layout of doors, windows and rooms are approximate should be regarded as such by any prospective purchaser. Any internal photographs are intended as a guide only and it should not be assumed that any of the furniture/fittings are included in any sale. Where shown, details of lease, ground rent and service charge are provided by the vendor and their accuracy cannot be guaranteed, as the information may not have been verified and further checks should be made either through your solicitor/conveyancer or by referring to the home information pack for this property. Where appliances, including central heating, are mentioned, it cannot be assumed that they are in working order, as they have not been tested. Please also note that wiring, plumbing and drains have not been checked.

