



**Broxholm Road, West Norwood, SE27**

**Kinleigh Folkard & Hayward**







## Broxholm Road, West Norwood, SE27

Guide price

£350,000

Shared Freehold

The property benefits from numerous original details and features a particularly spacious reception room ideal for entertaining. The immediate area is well served with a variety of shopping and leisure amenities as well as transport links to central London.

- GUIDE PRICE 350K-375K
- One double bedroom
- Bay fronted reception
- Period details
- Chain free
- Private garden
- Close to transport
- EPC rating D

Offered to market with no onward chain and providing a generous internal floor area is this light bright one bedroom period conversion which benefits from a sunny garden.

For more information or to arrange a viewing please contact:

### West Dulwich

113 Rosendale Road

Dulwich, SE21 8EZ

020 8761 0900

westdulwich.sales@kfh.co.uk

Kinleigh Folkard & Hayward

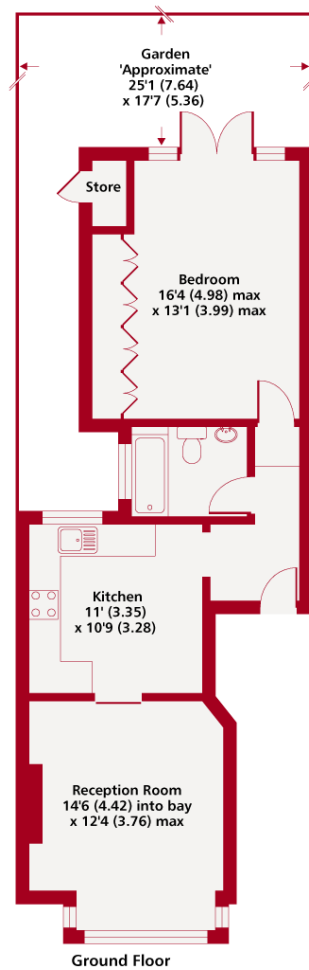

Broxholm Road SE27



Gross Internal Floor Area 591 sqft 54.9 sqm (excludes store)

Copyright nichecom.co.uk 2016 REF : 112292

Whilst every attempt has been made to ensure the accuracy of the floor plan contained here, measurements of doors, windows and rooms are approximate and no responsibility is taken for any error, omission or misstatement. These plans are for representation purposes only as defined by RICS Code of Measuring Practice and should be used as such by any prospective purchaser. Specifically no guarantee is given on the gross internal floor area of the property if quoted on this plan and any figure given is for initial guidance only and should not be relied on as a basis of valuation.

These particulars are believed to be correct but their accuracy is not guaranteed and they do not form part of any contract. Whilst every effort is made to ensure the accuracy of these details, it should be noted that the above measurements are approximate only. Floorplans are for representation purposes only and prepared according to the RICS Code of Measuring Practice by our floorplan provider. Therefore, the layout of doors, windows and rooms are approximate should be regarded as such by any prospective purchaser. Any internal photographs are intended as a guide only and it should not be assumed that any of the furniture/fittings are included in any sale. Where shown, details of lease, ground rent and service charge are provided by the vendor and their accuracy cannot be guaranteed, as the information may not have been verified and further checks should be made either through your solicitor/conveyancer or by referring to the home information pack for this property. Where appliances, including central heating, are mentioned, it cannot be assumed that they are in working order, as they have not been tested. Please also note that wiring, plumbing and drains have not been checked.

