



Macfarlane Road, Shepherd's Bush, W12

Kinleigh Folkard & Hayward







**Macfarlane Road,
Shepherd's Bush, W12**

Guide price

£500,000

Leasehold

—
This first floor two bedroom period conversion flat has been tastefully modernised throughout and offers an ideal purchase for a buy to let investor or first time purchaser alike.

- Chain Free Sale
- Amazing Location
- Close to Transport Links
- Two Bedrooms
- Large Reception Room
- Extended Lease 176 Years
- Modernised Throughout
- EPC Rating C

—
A charming two bedroom first floor flat situated on one of Shepherd's Bush's prime Roads. A stones throw from Shepherd's Bush Market Tube and Westfield Shopping Centre.

—
For more information or to arrange a viewing please contact:

Hammersmith
180 King Street
Hammersmith, W6 0RA
020 8563 9633
hammersmith.sales@kfh.co.uk

Kinleigh Folkard & Hayward

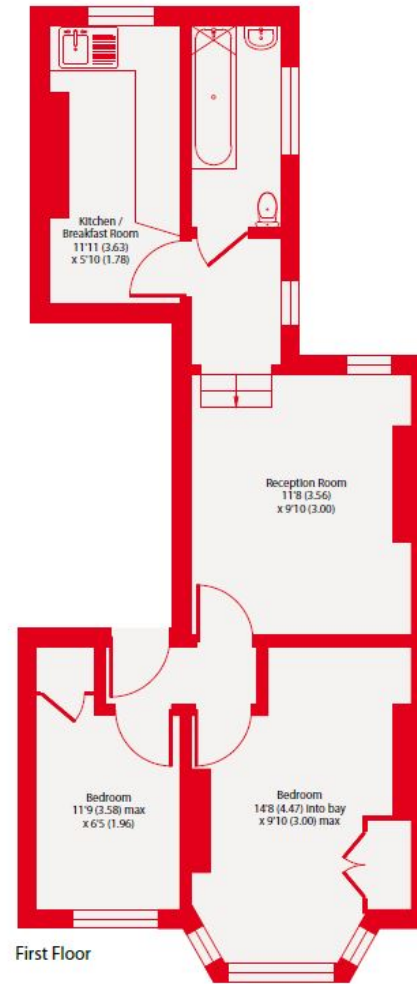

First Floor

Macfarlane Road, W12
 Approximate Area = 473 sq ft / 44 sq m
 For Identification only - Not to scale

Kinleigh Folkard & Hayward



Floor plan produced in accordance with RICS Property Measurement Standards incorporating International Property Measurement Standards (IPMS2 Residential). © nkhecom 2022. Produced for Kinleigh Folkard & Hayward. REF: 886707

These particulars are believed to be correct but their accuracy is not guaranteed and they do not form part of any contract. Whilst every effort is made to ensure the accuracy of these details, it should be noted that the above measurements are approximate only. Floorplans are for representation purposes only and prepared according to the RICS Code of Measuring Practice by our floorplan provider. Therefore, the layout of doors, windows and rooms are approximate should be regarded as such by any prospective purchaser. Any internal photographs are intended as a guide only and it should not be assumed that any of the furniture/fittings are included in any sale. Where shown, details of lease, ground rent and service charge are provided by the vendor and their accuracy cannot be guaranteed, as the information may not have been verified and further checks should be made either through your solicitor/conveyancer or by referring to the home information pack for this property. Where appliances, including central heating, are mentioned, it cannot be assumed that they are in working order, as they have not been tested. Please also note that wiring, plumbing and drains have not been checked.

