



Hatherley Grove, Bayswater, W2

Kinleigh Folkard & Hayward





Hatherley Grove, Bayswater, W2 £340,000 Leasehold

Hatherley Court is located in a quiet cul-de-sac moments from the many shops and restaurants of Queensway, Whiteleys Shopping Center, Waitrose as well as Queensway, Bayswater, Royal Oak and Paddington stations.

- Studio apartment
- Excellent condition
- Chain free
- Portered building
- Lift
- Off Westbourne Grove
- Cul de sac
- EPC rating C

A spacious apartment for sale in perfectly located Hatherley Grove. Presented in good condition, the flat is set within this popular building, directly off fashionable Westbourne Grove.

For more information or to arrange a viewing please contact:

Bayswater
186 Queensway
Bayswater, W2 6LY
020 7724 1222
bayswater.sales@kfh.co.uk

Kinleigh Folkard & Hayward

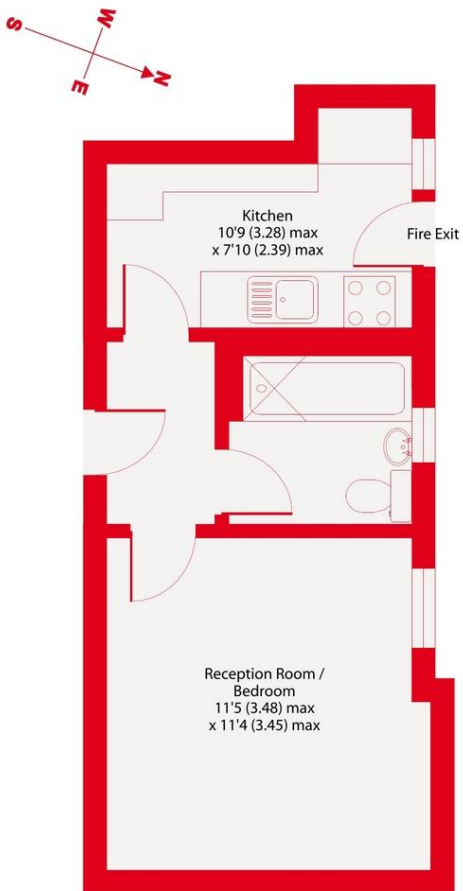

Fourth Floor

Hatherley Grove, W2
Approximate Area = 283 sq ft / 26.3 sq m
For identification only - Not to scale

Kinleigh Folkard & Hayward



Floor plan produced in accordance with RICS Property Measurement Standards incorporating International Property Measurement Standards (IPMS2 Residential). © nichecom 2022.
Produced for Kinleigh Folkard & Hayward. REF: 815718

These particulars are believed to be correct but their accuracy is not guaranteed and they do not form part of any contract. Whilst every effort is made to ensure the accuracy of these details, it should be noted that the above measurements are approximate only. Floorplans are for representation purposes only and prepared according to the RICS Code of Measuring Practice by our floorplan provider. Therefore, the layout of doors, windows and rooms are approximate should be regarded as such by any prospective purchaser. Any internal photographs are intended as a guide only and it should not be assumed that any of the furniture/fittings are included in any sale. Where shown, details of lease, ground rent and service charge are provided by the vendor and their accuracy cannot be guaranteed, as the information may not have been verified and further checks should be made either through your solicitor/conveyancer or by referring to the home information pack for this property. Where appliances, including central heating, are mentioned, it cannot be assumed that they are in working order, as they have not been tested. Please also note that wiring, plumbing and drains have not been checked.

