



**Mayfield Road, Wendell Park, W12**

**Kinleigh Folkard & Hayward**









## Mayfield Road, Wendell Park, W12

Guide price

£370,000

Leasehold

Located close to the popular Wendell Park and shops and amenities of Askew Road. Turnham Green, Acton Central and Stamford Brook tube stations are all within easy reach.

- 2 Bedrooms
- Leasehold 175 Years
- Allocated Parking Space
- Approx 488 Sq Ft
- Quiet Residential Area
- Wendell Park Nearby
- Top Floor Westerly Aspect
- EPC Rating C

Situated in the much sought after quiet development on Mayfield Road, a light flooded 2 bed flat. The lease has recently been extended and the property also benefits from allocated parking

For more information or to arrange a viewing please contact:

**Hammersmith**

180 King Street

Hammersmith, W6 0RA

020 8563 9633

hammersmith.sales@kfh.co.uk

Kinleigh Folkard & Hayward

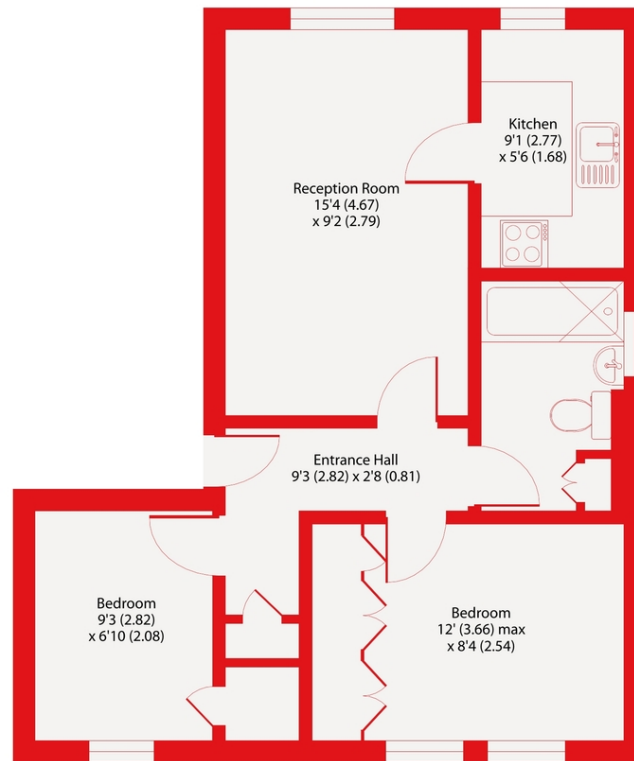

First Floor

Mayfield Road, W12  
Approximate Area = 488 sq ft / 45.3 sq m  
For identification only - Not to scale

Kinleigh Folkard & Hayward



Floor plan produced in accordance with RICS Property Measurement Standards incorporating International Property Measurement Standards (IPMS2 Residential). © nichecom 2024. Produced for Kinleigh Folkard & Hayward. REF: 1063406

These particulars are believed to be correct but their accuracy is not guaranteed and they do not form part of any contract. Whilst every effort is made to ensure the accuracy of these details, it should be noted that the above measurements are approximate only. Floorplans are for representation purposes only and prepared according to the RICS Code of Measuring Practice by our floorplan provider. Therefore, the layout of doors, windows and rooms are approximate should be regarded as such by any prospective purchaser. Any internal photographs are intended as a guide only and it should not be assumed that any of the furniture/fittings are included in any sale. Where shown, details of lease, ground rent and service charge are provided by the vendor and their accuracy cannot be guaranteed, as the information may not have been verified and further checks should be made either through your solicitor/conveyancer or by referring to the home information pack for this property. Where appliances, including central heating, are mentioned, it cannot be assumed that they are in working order, as they have not been tested. Please also note that wiring, plumbing and drains have not been checked.

