



Naomi Street, Deptford, SE8

Kinleigh Folkard & Hayward









## Naomi Street, Deptford, SE8

**£425,000**  
**Leasehold**

The property is situated in a great location within close proximity to transport links including Canada Water (Jubilee Line and Overground) and the Greenland Pier.

- One bedroom
- 5th floor with lift
- Secure bike storage
- Fully fitted kitchen
- Gym and 24hr concierge
- Underfloor heating
- 999 yr lease from 2016
- EPC rating B

A beautiful and bright one bedroom property boasting ample storage, south west facing balcony and access to a communal podium garden.

For more information or to arrange a viewing please contact:

**Canada Water**  
Montreal House  
Surrey Quays Road, SE16 7AQ  
020 7231 3800  
canadawater.sales@kfh.co.uk

**Kinleigh Folkard & Hayward**

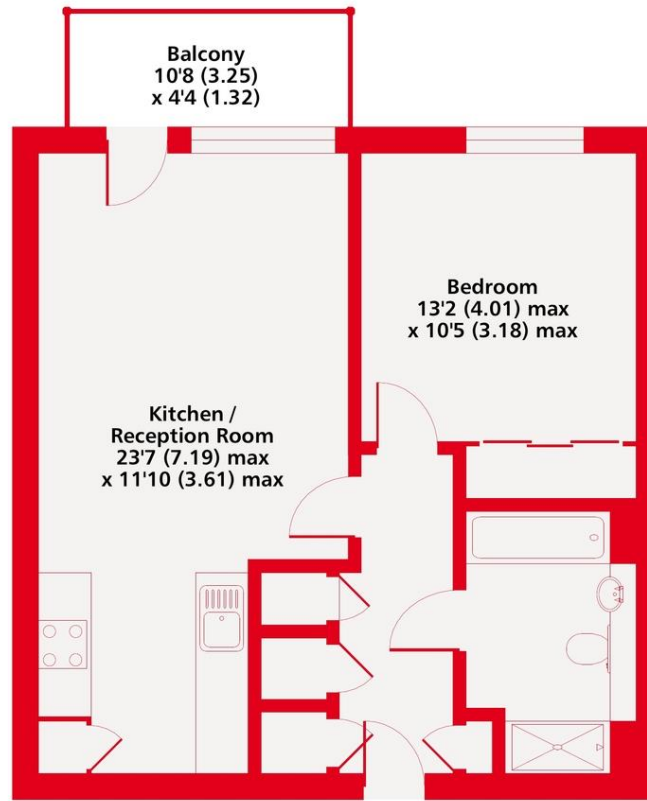

**Fifth Floor**

Naomi Street, SE8  
Approximate Area = 540 sq ft / 50.2 sq m  
For identification only - Not to scale

**Kinleigh Folkard & Hayward**



Floor plan produced in accordance with RICS Property Measurement Standards incorporating International Property Measurement Standards (IPMS2 Residential). © nichecom 2022.  
Produced for Kinleigh Folkard & Hayward. REF: 816301

These particulars are believed to be correct but their accuracy is not guaranteed and they do not form part of any contract. Whilst every effort is made to ensure the accuracy of these details, it should be noted that the above measurements are approximate only. Floorplans are for representation purposes only and prepared according to the RICS Code of Measuring Practice by our floorplan provider. Therefore, the layout of doors, windows and rooms are approximate should be regarded as such by any prospective purchaser. Any internal photographs are intended as a guide only and it should not be assumed that any of the furniture/fittings are included in any sale. Where shown, details of lease, ground rent and service charge are provided by the vendor and their accuracy cannot be guaranteed, as the information may not have been verified and further checks should be made either through your solicitor/conveyancer or by referring to the home information pack for this property. Where appliances, including central heating, are mentioned, it cannot be assumed that they are in working order, as they have not been tested. Please also note that wiring, plumbing and drains have not been checked.

