



Cheshire Street, Tower Hamlets, E2

Kinleigh Folkard & Hayward







**Cheshire Street,
Tower Hamlets, E2**
£600,000
Leasehold

Situated in a prime spot this wonderful home is perfectly situated in the heart of Shoreditch. Liverpool Street & Shoreditch stations are just a short walk away, alongside some of the best bars & restaurants London has to offer.

- Two double bedrooms
- Private roof terrace
- City views
- Underground parking
- No chain
- Close to Shoreditch tube
- Well presented
- EPC rating C

An immaculate two bedroom penthouse set in the heart of Shoreditch. The property benefits from a private wrap around terrace with the most fantastic views of The City.

For more information or to arrange a viewing please contact:

Clerkenwell
132-136 St John Street
Clerkenwell, EC1V 4JT
020 7563 5060
clerkenwell.sales@kfh.co.uk

Kinleigh Folkard & Hayward



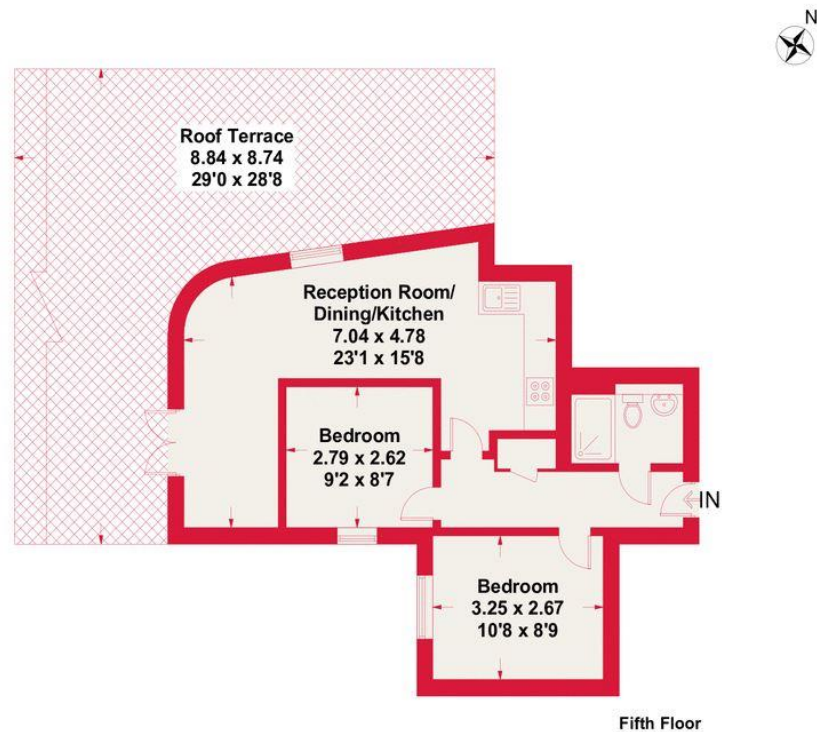

Cheshire Street

Approximate Gross Internal Area = 540 sq ft / 50.2 sq m

Kinleigh Folkard & Hayward

Whilst every attempt has been made to ensure the accuracy of the floor plan contained here, measurements of doors, windows and rooms are approximate and no responsibility is taken for any error, omission or misstatement. These plans are for representation purposes only as defined by RICS Code of Measuring Practice and should be used as such by any prospective purchaser. Specifically no guarantee is given on the gross internal floor area of the property if quoted on this plan and any figure given is for initial guidance only and should not be relied on as a basis of valuation.

These particulars are believed to be correct but their accuracy is not guaranteed and they do not form part of any contract. Whilst every effort is made to ensure the accuracy of these details, it should be noted that the above measurements are approximate only. Floorplans are for representation purposes only and prepared according to the RICS Code of Measuring Practice by our floorplan provider. Therefore, the layout of doors, windows and rooms are approximate should be regarded as such by any prospective purchaser. Any internal photographs are intended as a guide only and it should not be assumed that any of the furniture/fittings are included in any sale. Where shown, details of lease, ground rent and service charge are provided by the vendor and their accuracy cannot be guaranteed, as the information may not have been verified and further checks should be made either through your solicitor/conveyancer or by referring to the home information pack for this property. Where appliances, including central heating, are mentioned, it cannot be assumed that they are in working order, as they have not been tested. Please also note that wiring, plumbing and drains have not been checked.

