



England's Lane, *Belsize Park NW3*







A contemporary home ideally suited for modern city living.



England's Lane,  
*Belsize Park NW3*  
£1,200,000  
Leasehold

For sale is this stunning duplex apartment that occupies a prime location in the heart of Belsize Park, offering fantastic views of the city and has been beautifully refurbished throughout.

- Three bedrooms
- Two luxury bathrooms
- High spec kitchen
- Large reception room
- South facing roof terrace
- Cloakroom & 3rd W.C
- Close to the Northern line
- No upward chain
- EPC Rating E

See all our properties at  
 **OnTheMarket**.com

For more information or to arrange a viewing please contact:

**Belsize Park**  
38 England's Lane,  
London NW3 4UE

**Sales**  
Tel 020 7483 4302  
belsizepark.sales@kfh.co.uk

Kinleigh Folkard & Hayward

kfh.co.uk

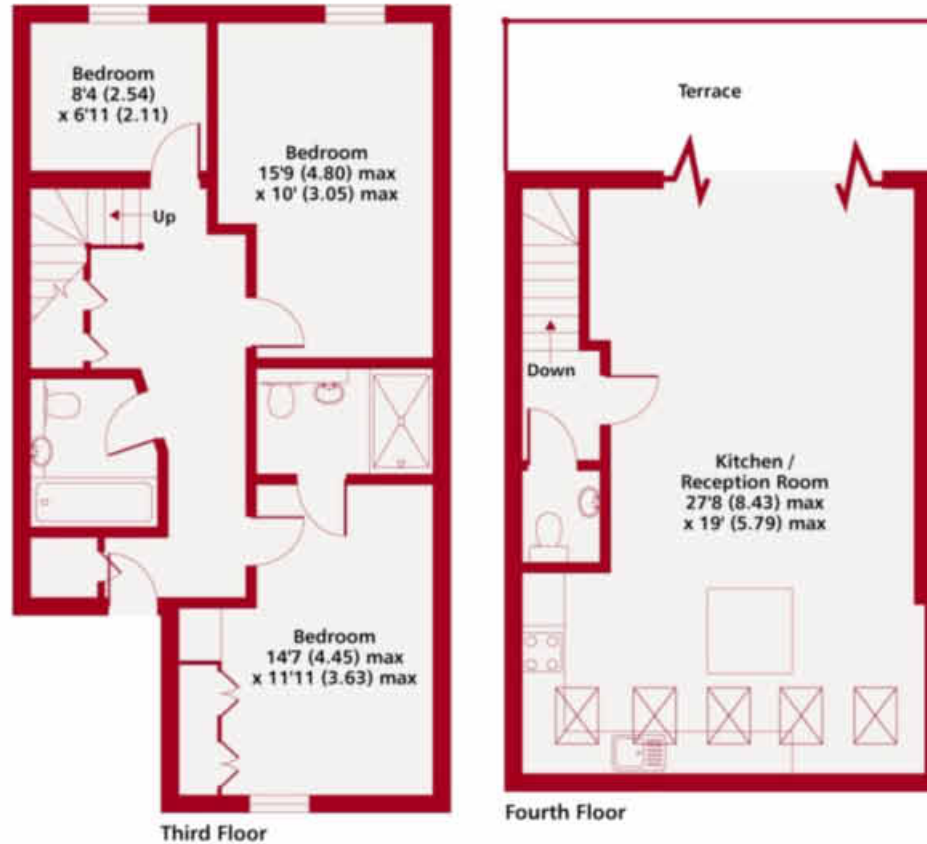

Englands Lane NW3



Gross Internal Floor Area 1144 sqft 106.3 sqm

Copyright nichecom.co.uk 2015 REF : 27232

Whilst every attempt has been made to ensure the accuracy of the floor plan contained here, measurements of doors, windows and rooms are approximate and no responsibility is taken for any error, omission or misstatement. These plans are for representation purposes only as defined by RICS Code of Measuring Practice and should be used as such by any prospective purchaser. Specifically no guarantee is given on the gross internal floor area of the property if quoted on this plan and any figure given is for initial guidance only and should not be relied on as a basis of valuation.