



**Blandford Street, Marylebone, W1U**

Kinleigh Folkard & Hayward







**Blandford Street,  
Marylebone, W1U**  
**£650,000**  
**Leasehold**

Blandford Street is located just moments away from the shops, bars and restaurants of Baker Street and Marylebone High Street, while London's vibrant West End is also within easy reach.

Baker Street underground station is within easy reach.

- Reception room
- Kitchen
- Bedroom
- Period Conversion
- Top floor
- EPC rating D

A bright one bedroom flat situated on one of the most popular streets in Marylebone. The flat offers open plan living with a fully fitted kitchen, double bedroom and ample attic storage.

For more information or to arrange a viewing please contact:

**Marylebone**  
136 Baker Street  
Marylebone, W1U 6FL  
020 7486 5551  
marylebone.sales@kfh.co.uk

**Kinleigh Folkard & Hayward**

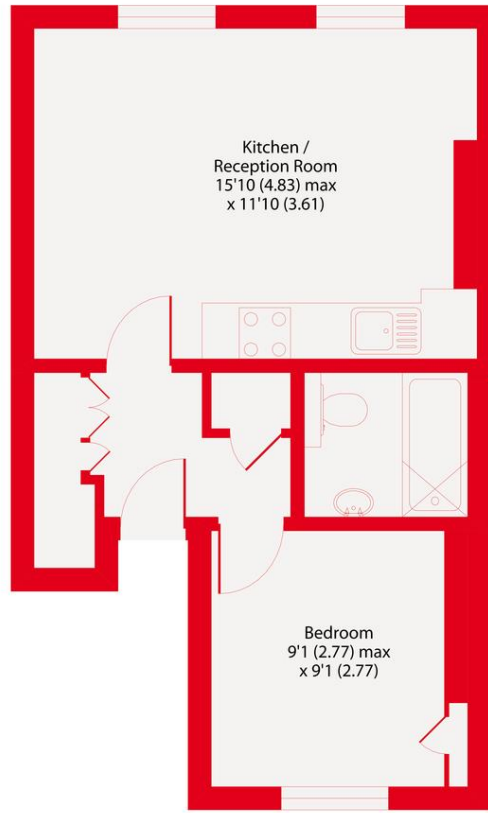

Third Floor

Blandford Street, W1U  
Approximate Area = 367 sq ft / 34.1 sq m  
For identification only - Not to scale

Kinleigh Folkard & Hayward



Floor plan produced in accordance with RICS Property Measurement Standards incorporating International Property Measurement Standards (IPMS2 Residential). © nichecom 2021. Produced for Kinleigh Folkard & Hayward. REF: 781745

These particulars are believed to be correct but their accuracy is not guaranteed and they do not form part of any contract. Whilst every effort is made to ensure the accuracy of these details, it should be noted that the above measurements are approximate only. Floorplans are for representation purposes only and prepared according to the RICS Code of Measuring Practice by our floorplan provider. Therefore, the layout of doors, windows and rooms are approximate should be regarded as such by any prospective purchaser. Any internal photographs are intended as a guide only and it should not be assumed that any of the furniture/fittings are included in any sale. Where shown, details of lease, ground rent and service charge are provided by the vendor and their accuracy cannot be guaranteed, as the information may not have been verified and further checks should be made either through your solicitor/conveyancer or by referring to the home information pack for this property. Where appliances, including central heating, are mentioned, it cannot be assumed that they are in working order, as they have not been tested. Please also note that wiring, plumbing and drains have not been checked.

