



Scrubs Lane, Hammersmith and Fulham, NW10

Kinleigh Folkard & Hayward







**Scrubs Lane,
Hammersmith and
Fulham, NW10**
£435,000
Shared Freehold

The property is perfectly located for Kensal Green & Willesden Junction (Bakerloo line and Overground), Kensal Rise (Overground) stations as well as the numerous coffee shops, restaurants, gastro pubs and desirable amenities of Park Parade,

- Three double bedrooms
- Split level maisonette
- Chain free
- 705 sqft
- Victorian conversion
- excellent transport links

A well proportioned and well maintained, three bedroom split level maisonette sold chain free along with a long lease. The apartment is located within a lovely Victorian conversion.

For more information or to arrange a viewing please contact:

Queens Park
49 Salusbury Road
Queens Park, NW6 6NL
020 3962 3050
queenspark.sales@kfh.co.uk

Kinleigh Folkard & Hayward

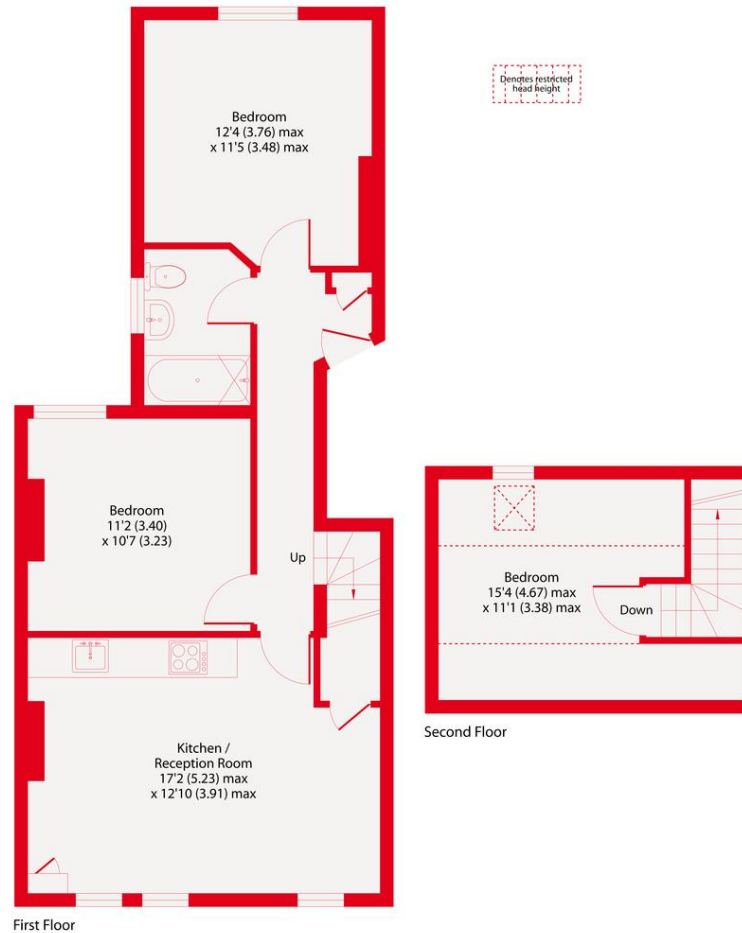

First Floor

Second Floor

Scrubs Lane, NW10
 Approximate Area = 705 sq ft / 65.5 sq m
 Including Limited Use Area(s) = 85 sq ft / 7.9 sq m
 Total = 790 sq ft / 73.4 sq m
 For identification only - Not to scale

Kinleigh Folkard & Hayward



Floor plan produced in accordance with RICS Property Measurement Standards incorporating International Property Measurement Standards (IPMS2 Residential). © nichecom 2021. Produced for Kinleigh Folkard & Hayward. REF: 771373

These particulars are believed to be correct but their accuracy is not guaranteed and they do not form part of any contract. Whilst every effort is made to ensure the accuracy of these details, it should be noted that the above measurements are approximate only. Floorplans are for representation purposes only and prepared according to the RICS Code of Measuring Practice by our floorplan provider. Therefore, the layout of doors, windows and rooms are approximate should be regarded as such by any prospective purchaser. Any internal photographs are intended as a guide only and it should not be assumed that any of the furniture/fittings are included in any sale. Where shown, details of lease, ground rent and service charge are provided by the vendor and their accuracy cannot be guaranteed, as the information may not have been verified and further checks should be made either through your solicitor/conveyancer or by referring to the home information pack for this property. Where appliances, including central heating, are mentioned, it cannot be assumed that they are in working order, as they have not been tested. Please also note that wiring, plumbing and drains have not been checked.

