



Old Brompton Road, Earls Court, SW5

Kinleigh Folkard & Hayward







**Old Brompton Road,
Earls Court, SW5**
£725,000
Leasehold

A variety of shops, restaurants and amenities are a short distance away, as well as transport links via Earl's Court and West Brompton stations for two tube lines and National Rail services. The flat comes complete with access to a quiet communal garden.

- TWO BEDROOMS
- LIVING ROOM
- KITCHEN
- BATHROOM
- TOP FLOOR
- LIFT
- PORTERED BUILDING

Two bedroom flat situated on the top floor of this well maintained portered Art-deco building. The property requires modernisation throughout. An internal viewing is highly recommended.

For more information or to arrange a viewing please contact:

Earls Court
243 Old Brompton Road
Kensington, SW5 9HP
020 7740 2020
earlscourt.sales@kfh.co.uk

Kinleigh Folkard & Hayward

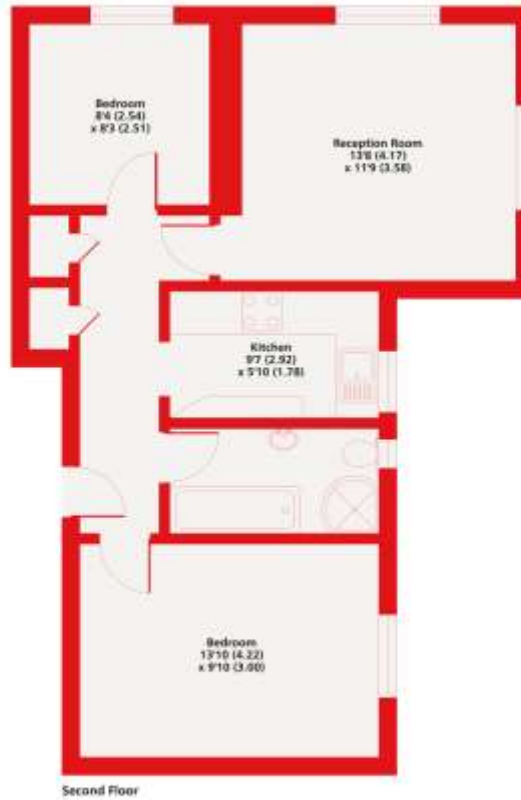

Redcliffe Close, SW5
 Approximate Area = 577 sq ft / 53.6 sq m
 For identification only - Not to scale

Kinleigh Folkard & Hayward



Floor plan produced in accordance with RICS Property Measurement Standards incorporating International Property Measurement Standards (IPMS Residential) - 8th Edition 2021. Produced by Kinleigh Folkard & Hayward - RFPF 18/02/22

These particulars are believed to be correct but their accuracy is not guaranteed and they do not form part of any contract. Whilst every effort is made to ensure the accuracy of these details, it should be noted that the above measurements are approximate only. Floorplans are for representation purposes only and prepared according to the RICS Code of Measuring Practice by our floorplan provider. Therefore, the layout of doors, windows and rooms are approximate and should be regarded as such by any prospective purchaser. Any internal photographs are intended as a guide only and it should not be assumed that any of the furniture/fittings are included in any sale. Where shown, details of lease, ground rent and service charge are provided by the vendor and their accuracy cannot be guaranteed, as the information may not have been verified and further checks should be made either through your solicitor/conveyancer or by referring to the home information pack for this property. Where appliances, including central heating, are mentioned, it cannot be assumed that they are in working order, as they have not been tested. Please also note that wiring, plumbing and drains have not been checked.

