



Hamlet Gardens, Hammersmith, W6

Kinleigh Folkard & Hayward







Hamlet Gardens, Hammersmith, W6

£265,000
Leasehold

This desirable studio is located just moments from great bars, restaurants and shops with the scenic Ravenscourt Park very close by.

Chiswick High Road, the riverside and Stamford Brook Tube are all just a short walk away.

- Generous studio room
- Sleek modern kitchen
- Stylish bathroom
- Recently refurbished
- Porter in the block
- Vacant and chain free
- Bars & restaurants nearby
- Park & Tube nearby

A bright, good-sized studio within the popular, art-deco Kings Court development, just off King Street, W6. Recently refurbished throughout and presented in excellent condition.

For more information or to arrange a viewing please contact:

Hammersmith
180 King Street
Hammersmith, W6 0RA
020 8563 9633
hammersmith.sales@kfh.co.uk

Kinleigh Folkard & Hayward

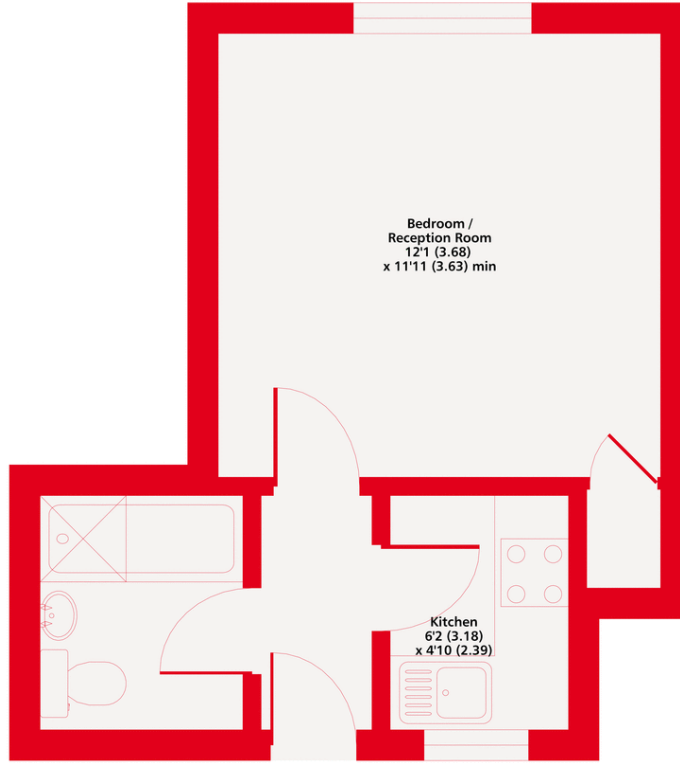

Fifth Floor

Kings Court, W6
Approximate Area = 247 sq ft / 22.9 sq m
For identification only - Not to scale

Kinleigh Folkard & Hayward



Floor plan produced in accordance with RICS Property Measurement Standards incorporating International Property Measurement Standards (IPMS2 Residential). © nchecon 2021. Produced for Kinleigh Folkard & Hayward. REF: 721230

These particulars are believed to be correct but their accuracy is not guaranteed and they do not form part of any contract. Whilst every effort is made to ensure the accuracy of these details, it should be noted that the above measurements are approximate only. Floorplans are for representation purposes only and prepared according to the RICS Code of Measuring Practice by our floorplan provider. Therefore, the layout of doors, windows and rooms are approximate should be regarded as such by any prospective purchaser. Any internal photographs are intended as a guide only and it should not be assumed that any of the furniture/fittings are included in any sale. Where shown, details of lease, ground rent and service charge are provided by the vendor and their accuracy cannot be guaranteed, as the information may not have been verified and further checks should be made either through your solicitor/conveyancer or by referring to the home information pack for this property. Where appliances, including central heating, are mentioned, it cannot be assumed that they are in working order, as they have not been tested. Please also note that wiring, plumbing and drains have not been checked.

