



Mayfield Road, Shepherds Bush, W12

Kinleigh Folkard & Hayward







**Mayfield Road,
Shepherds Bush, W12**
£315,000
Leasehold

Offering residents parking and no onward chain this property is ideal for those looking for something to move straight into.

- One Bedroom
- Second Floor
- Leasehold
- Well Presented
- No Onward Chain
- EPC Rating C

Situated in a quiet and much sought after building sits this well maintained one bedroom apartment.

For more information or to arrange a viewing please contact:

Hammersmith
180 King Street
Hammersmith, W6 0RA
020 8563 9633
hammersmith.sales@kfh.co.uk

Kinleigh Folkard & Hayward



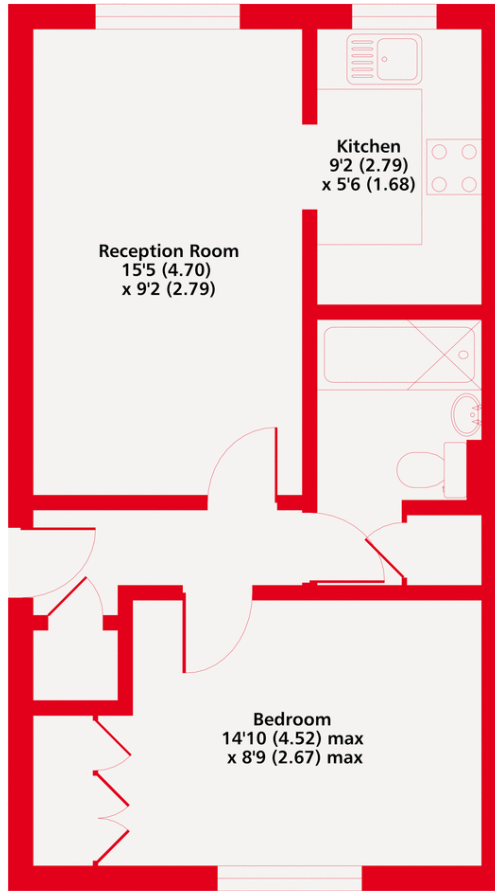

Second Floor

Mayfield Road, W12
 Approximate Area = 417 sq ft / 38.7 sq m
 For identification only - Not to scale

Kinleigh Folkard & Hayward



Floor plan produced in accordance with RICS Property Measurement Standards incorporating International Property Measurement Standards (IPMS2 Residential). © ncheccom 2021. Produced for Kinleigh Folkard & Hayward. REF: 758683

These particulars are believed to be correct but their accuracy is not guaranteed and they do not form part of any contract. Whilst every effort is made to ensure the accuracy of these details, it should be noted that the above measurements are approximate only. Floorplans are for representation purposes only and prepared according to the RICS Code of Measuring Practice by our floorplan provider. Therefore, the layout of doors, windows and rooms are approximate should be regarded as such by any prospective purchaser. Any internal photographs are intended as a guide only and it should not be assumed that any of the furniture/fittings are included in any sale. Where shown, details of lease, ground rent and service charge are provided by the vendor and their accuracy cannot be guaranteed, as the information may not have been verified and further checks should be made either through your solicitor/conveyancer or by referring to the home information pack for this property. Where appliances, including central heating, are mentioned, it cannot be assumed that they are in working order, as they have not been tested. Please also note that wiring, plumbing and drains have not been checked.

