



River Rise Close, Deptford, SE8

Kinleigh Folkard & Hayward







**River Rise Close,
Deptford, SE8**
£550,000
Leasehold

- Two double bedrooms
- Two bathrooms
- Private terrace
- Modern fixture & fittings
- Open plan living
- CHAIN FREE
- 810sq ft or 75.2sq m
- EPC Rating B

A spacious two bedroom two bathroom modern apartment. Located in the popular Greenland Place development a short walk to the Dock, transport and amenities of Surrey Quays.

For more information or to arrange a viewing please contact:

Canada Water
Montreal House
Surrey Quays Road, SE16 7AQ
020 7231 3800
canadawater.sales@kfh.co.uk

Kinleigh Folkard & Hayward

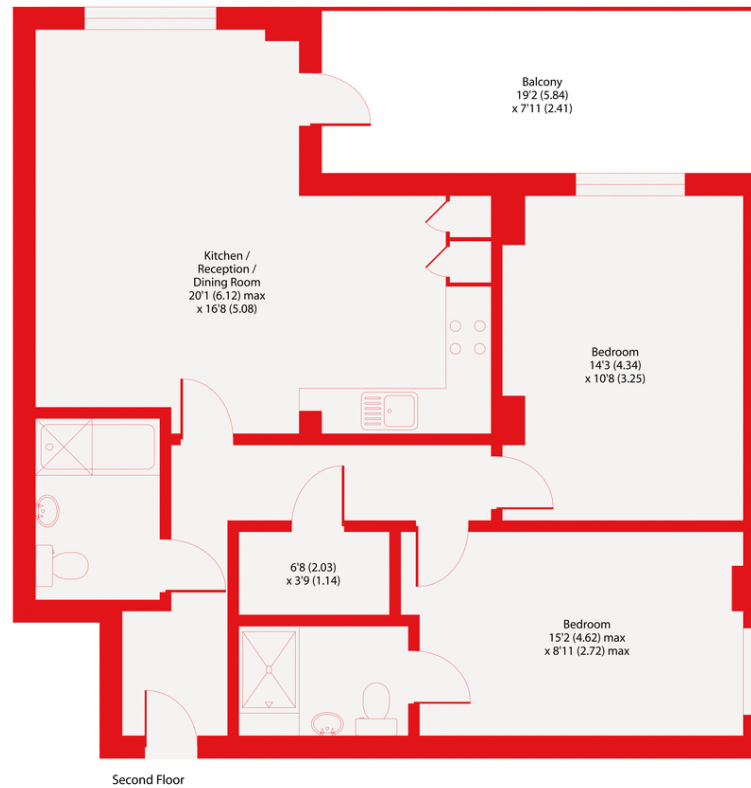

River Rise Close, SE8
Approximate Area = 810 sq ft / 75.2 sq m
For identification only - Not to scale

Kinleigh Folkard & Hayward



Floor plan produced in accordance with RICS Property Measurement Standards incorporating International Property Measurement Standards (IPMS2 Residential). © nchecon 2021. Produced for Kinleigh Folkard & Hayward. REF: 754263

These particulars are believed to be correct but their accuracy is not guaranteed and they do not form part of any contract. Whilst every effort is made to ensure the accuracy of these details, it should be noted that the above measurements are approximate only. Floorplans are for representation purposes only and prepared according to the RICS Code of Measuring Practice by our floorplan provider. Therefore, the layout of doors, windows and rooms are approximate should be regarded as such by any prospective purchaser. Any internal photographs are intended as a guide only and it should not be assumed that any of the furniture/fittings are included in any sale. Where shown, details of lease, ground rent and service charge are provided by the vendor and their accuracy cannot be guaranteed, as the information may not have been verified and further checks should be made either through your solicitor/conveyancer or by referring to the home information pack for this property. Where appliances, including central heating, are mentioned, it cannot be assumed that they are in working order, as they have not been tested. Please also note that wiring, plumbing and drains have not been checked.

