



Queensway, Bayswater, W2

Kinleigh Folkard & Hayward







**Queensway,
Bayswater, W2
£475,000
Leasehold**

Located at the northern end of Queensway, Arthur Court is a handsome and well regarded portered building providing immediate access to the many shops and restaurants of fashionable Westbourne Grove and a short walk to Hyde Park.

- One bedroom
- Double reception
- Bright and airy
- Excellent condition
- Portorage
- Lease - 50 years
- EPC rating tbc

A bright and spacious one bedroom apartment in the heart of Queensway. In excellent condition and benefiting from a double reception, this would make an ideal investment.

For more information or to arrange a viewing please contact:

Bayswater
186 Queensway
Bayswater, W2 6LY
020 7724 1222
bayswater.sales@kfh.co.uk

Kinleigh Folkard & Hayward

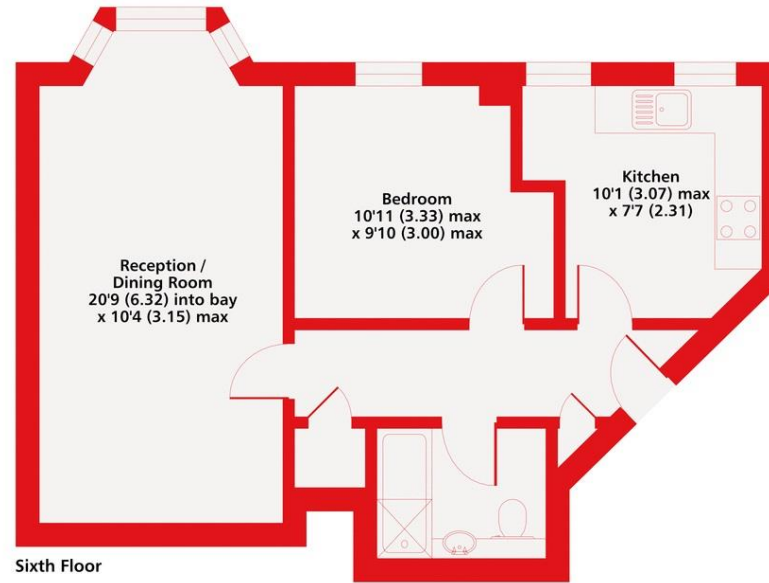

Sixth Floor

Queensway, W2
 Approximate Area = 562 sq ft / 52.2 sq m
 For identification only - Not to scale

Kinleigh Folkard & Hayward



This floor plan was constructed using measurements provided to ©nichecom 2021 by a third party. Produced for Kinleigh Folkard & Hayward. REF: 753580

These particulars are believed to be correct but their accuracy is not guaranteed and they do not form part of any contract. Whilst every effort is made to ensure the accuracy of these details, it should be noted that the above measurements are approximate only. Floorplans are for representation purposes only and prepared according to the RICS Code of Measuring Practice by our floorplan provider. Therefore, the layout of doors, windows and rooms are approximate should be regarded as such by any prospective purchaser. Any internal photographs are intended as a guide only and it should not be assumed that any of the furniture/fittings are included in any sale. Where shown, details of lease, ground rent and service charge are provided by the vendor and their accuracy cannot be guaranteed, as the information may not have been verified and further checks should be made either through your solicitor/conveyancer or by referring to the home information pack for this property. Where appliances, including central heating, are mentioned, it cannot be assumed that they are in working order, as they have not been tested. Please also note that wiring, plumbing and drains have not been checked.

