



**Hatherley Grove, Bayswater, W2**

**Kinleigh Folkard & Hayward**







## Hatherley Grove, Bayswater, W2

Guide price

£700,000

Shared Freehold

Hatherley Grove is conveniently located within an easy walk of the shops, restaurants and cafes of Westbourne Grove and Portobello Road. The lush green open spaces of Hyde Park are also a short walk away. There is also a choice of transport links at Queensway.

- Two bedrooms
- Open-plan reception
- Fitted modern kitchen
- Bright dual aspect
- Period building
- Moments from shops
- Energy rating C

This fantastic flat boasts a rare, bright and unusually spacious open-plan living room, fitted kitchen and diner, within a white stucco building, only steps from Westbourne Grove!

For more information or to arrange a viewing please contact:

### Bayswater

186 Queensway  
Bayswater, W2 6LY  
020 7724 1222  
bayswater.sales@kfh.co.uk

Kinleigh Folkard & Hayward

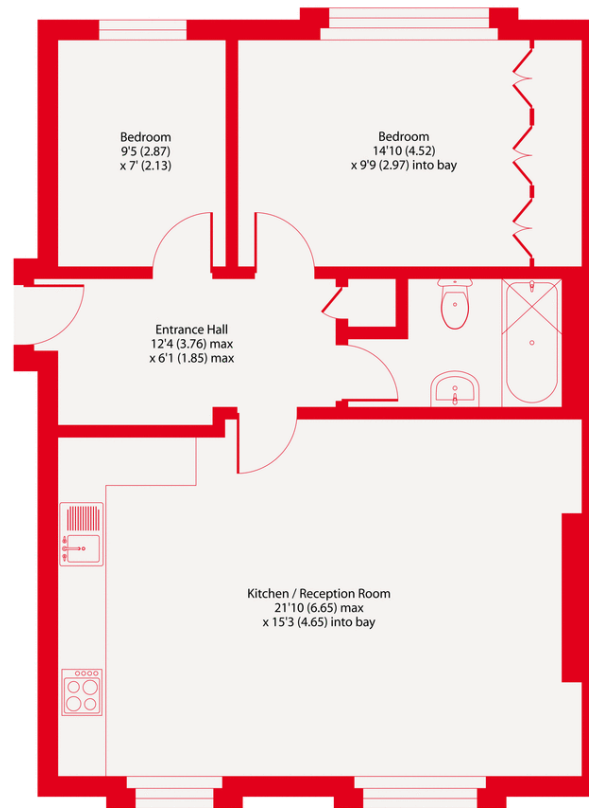

Third Floor

Hatherley Grove, W2  
 Approximate Area = 679 sq ft / 63 sq m  
 For identification only - Not to scale

Kinleigh Folkard & Hayward



Floor plan produced in accordance with RICS Property Measurement Standards incorporating International Property Measurement Standards (IPMS2 Residential). © nchecon 2021. Produced for Kinleigh Folkard & Hayward. REF: 760221

These particulars are believed to be correct but their accuracy is not guaranteed and they do not form part of any contract. Whilst every effort is made to ensure the accuracy of these details, it should be noted that the above measurements are approximate only. Floorplans are for representation purposes only and prepared according to the RICS Code of Measuring Practice by our floorplan provider. Therefore, the layout of doors, windows and rooms are approximate should be regarded as such by any prospective purchaser. Any internal photographs are intended as a guide only and it should not be assumed that any of the furniture/fittings are included in any sale. Where shown, details of lease, ground rent and service charge are provided by the vendor and their accuracy cannot be guaranteed, as the information may not have been verified and further checks should be made either through your solicitor/conveyancer or by referring to the home information pack for this property. Where appliances, including central heating, are mentioned, it cannot be assumed that they are in working order, as they have not been tested. Please also note that wiring, plumbing and drains have not been checked.

