



St. Peters Way, Ealing, W5

Kinleigh Folkard & Hayward







**St. Peters Way,
Ealing, W5**

OIEO

£550,000

Leasehold

Perfectly positioned for local schools, the green spaces of Montpelier park.

- Chain free
- Two bedrooms
- Kitchen
- Spacious living room
- Bathroom
- Communal grounds
- EPC rating C

Available immediately, this well presented, two bedroom first floor flat, is located on a quiet turning in easy reach of both Ealing Broadway and Pitshanger Lane's local shops and restaurants

For more information or to arrange a viewing please contact:

Ealing
45 The Mall
Ealing, W5 3TJ
020 8799 3890
ealing.sales@kfh.co.uk

Kinleigh Folkard & Hayward

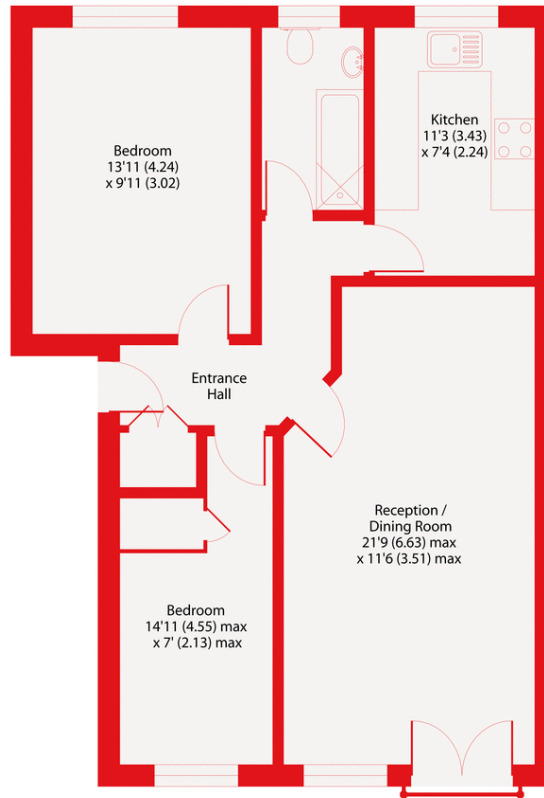

First Floor

St. Peters Way, WS
Approximate Area = 695 sq ft / 64.6 sq m
For identification only - Not to scale

Kinleigh Folkard & Hayward



Floor plan produced in accordance with RICS Property Measurement Standards incorporating International Property Measurement Standards (IPMS2 Residential). © ncheccom 2021. Produced for Kinleigh Folkard & Hayward. REF: 711512

These particulars are believed to be correct but their accuracy is not guaranteed and they do not form part of any contract. Whilst every effort is made to ensure the accuracy of these details, it should be noted that the above measurements are approximate only. Floorplans are for representation purposes only and prepared according to the RICS Code of Measuring Practice by our floorplan provider. Therefore, the layout of doors, windows and rooms are approximate should be regarded as such by any prospective purchaser. Any internal photographs are intended as a guide only and it should not be assumed that any of the furniture/fittings are included in any sale. Where shown, details of lease, ground rent and service charge are provided by the vendor and their accuracy cannot be guaranteed, as the information may not have been verified and further checks should be made either through your solicitor/conveyancer or by referring to the home information pack for this property. Where appliances, including central heating, are mentioned, it cannot be assumed that they are in working order, as they have not been tested. Please also note that wiring, plumbing and drains have not been checked.

