



Debnams Road, South Bermondsey, SE16

Kinleigh Folkard & Hayward







**Debnams Road,
South
Bermondsey, SE16**
OIEO
£350,000
Leasehold

- Bedroom with office space
- Secure allocated parking
- Transport links nearby
- Private terrace
- EWS1 compliant
- Modern fixture & fittings
- 557sq ft or 51.7sq m
- EPC Rating B

A stunning apartment with great links to London Bridge and far reaching views taking in The City and Shard. A great first buy, beautifully presented. Viewings are recommended.

For more information or to arrange a viewing please contact:

Canada Water
Montreal House
Surrey Quays Road, SE16 7AQ
020 7231 3800
canadawater.sales@kfh.co.uk

Kinleigh Folkard & Hayward



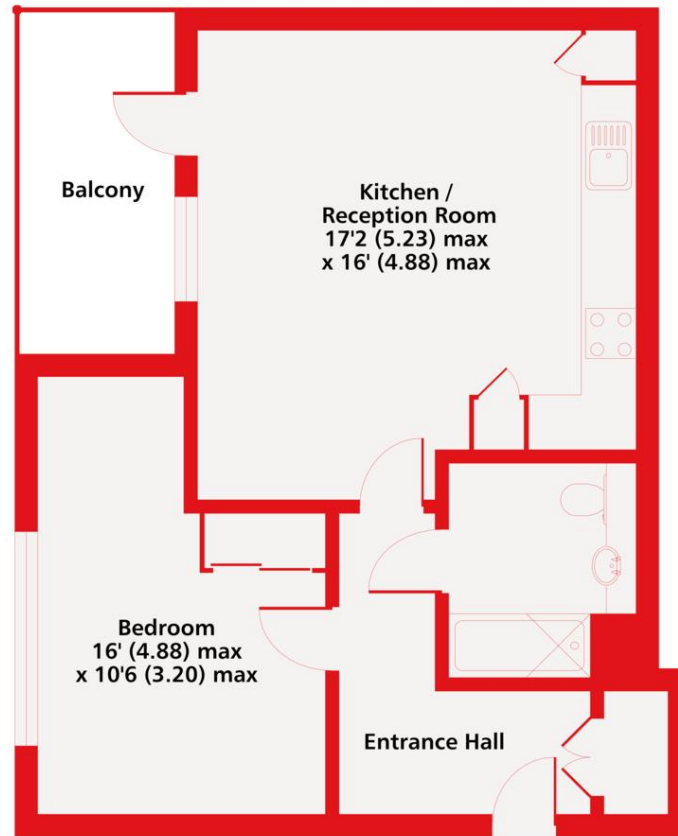

Third Floor

Debnams Road, SE16
 Approximate Area = 557 sq ft / 51.7 sq m
 For identification only - Not to scale

Kinleigh Folkard & Hayward



Floor plan produced in accordance with RICS Property Measurement Standards incorporating International Property Measurement Standards (IPMS2 Residential). © nichecom 2021. Produced for Kinleigh Folkard & Hayward. REF: 795632

These particulars are believed to be correct but their accuracy is not guaranteed and they do not form part of any contract. Whilst every effort is made to ensure the accuracy of these details, it should be noted that the above measurements are approximate only. Floorplans are for representation purposes only and prepared according to the RICS Code of Measuring Practice by our floorplan provider. Therefore, the layout of doors, windows and rooms are approximate should be regarded as such by any prospective purchaser. Any internal photographs are intended as a guide only and it should not be assumed that any of the furniture/fittings are included in any sale. Where shown, details of lease, ground rent and service charge are provided by the vendor and their accuracy cannot be guaranteed, as the information may not have been verified and further checks should be made either through your solicitor/conveyancer or by referring to the home information pack for this property. Where appliances, including central heating, are mentioned, it cannot be assumed that they are in working order, as they have not been tested. Please also note that wiring, plumbing and drains have not been checked.

