



Monmouth Road, Bayswater, W2

Kinleigh Folkard & Hayward







**Monmouth Road,
Bayswater, W2**
£1,199,000
Shared Freehold

Westbourne Grove offers a wealth of fashionable eateries, with the amenities of Queensway a short stroll away. Portobello Road and the delights of Notting Hill are also close by, as well as Hyde Park.



- Superb location
- Secure building
- Excellent condition
- Lift
- Separate kitchen
- Shared freehold
- Energy Rating D

Wonderfully located on a picturesque street just off stylish Westbourne Grove, this spacious apartment boasts stunning high ceilings and is presented in excellent condition throughout.

For more information or to arrange a viewing please contact:

Bayswater
186 Queensway
Bayswater, W2 6LY
020 7724 1222
bayswater.sales@kfh.co.uk

Kinleigh Folkard & Hayward

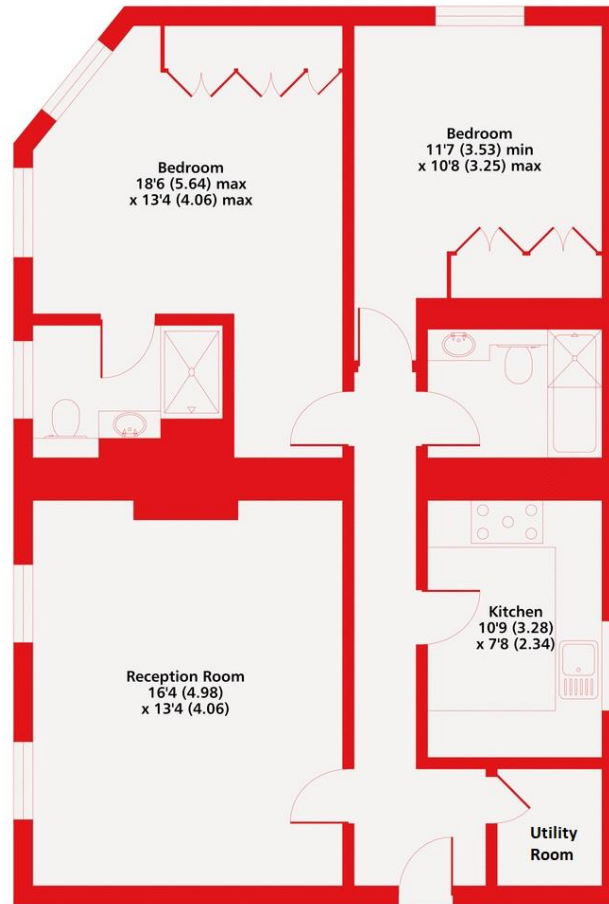

Second Floor

Monmouth Road, W2
 Approximate Area = 890 sq ft / 82.7 sq m
 For identification only - Not to scale

Kinleigh Folkard & Hayward



Floor plan produced in accordance with RICS Property Measurement Standards incorporating International Property Measurement Standards (IPMS2 Residential). © nchecon 2021. Produced for Kinleigh Folkard & Hayward. REF: 730040

These particulars are believed to be correct but their accuracy is not guaranteed and they do not form part of any contract. Whilst every effort is made to ensure the accuracy of these details, it should be noted that the above measurements are approximate only. Floorplans are for representation purposes only and prepared according to the RICS Code of Measuring Practice by our floorplan provider. Therefore, the layout of doors, windows and rooms are approximate should be regarded as such by any prospective purchaser. Any internal photographs are intended as a guide only and it should not be assumed that any of the furniture/fittings are included in any sale. Where shown, details of lease, ground rent and service charge are provided by the vendor and their accuracy cannot be guaranteed, as the information may not have been verified and further checks should be made either through your solicitor/conveyancer or by referring to the home information pack for this property. Where appliances, including central heating, are mentioned, it cannot be assumed that they are in working order, as they have not been tested. Please also note that wiring, plumbing and drains have not been checked.

