



Chambers Park Hill, West Wimbledon, SW20

Kinleigh Folkard & Hayward







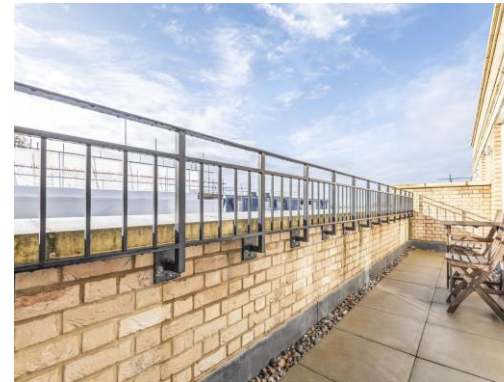

**Chambers Park Hill,  
West  
Wimbledon, SW20  
£699,950  
Leasehold**

This lovely property boasts fantastic dimensions throughout and benefits from direct access to a private balcony with a southerly aspect and impressively maintained communal grounds.

- Excellent condition
- Two double bedrooms
- Stylish bathroom
- Generous reception
- Off-street parking
- Private balcony
- No onward chain
- EPC rating B

A superb opportunity to purchase this stunning two bedroom apartment located in this modern and sought after Berkeley Homes development situated moments from Wimbledon Common.

For more information or to arrange a viewing please contact:

**Raynes Park**  
1a Station Buildings  
5-9 Coombe Lane, Raynes Park, SW20 8NE  
020 3542 2000  
raynespark.sales@kfh.co.uk

**Kinleigh Folkard & Hayward**



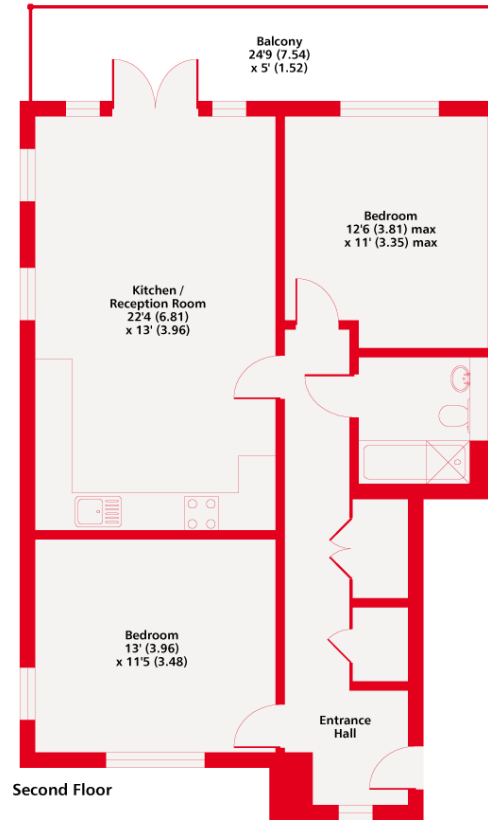

Chambers Park Hill SW20  
Gross Internal Floor Area 797 sqft 74 sqm  
Copyright nichecom.co.uk 2019 REF : 547265

Kinleigh Folkard & Hayward

Whilst every attempt has been made to ensure the accuracy of the floor plan contained here, measurements of doors, windows and rooms are approximate and no responsibility is taken for any error, omission or misstatement. These plans are for representation purposes only as defined by RICS Code of Measuring Practice and should be used as such by any prospective purchaser. Specifically no guarantee is given on the gross internal floor area of the property if quoted on this plan and any figure given is for initial guidance only and should not be relied on as a basis of valuation.

These particulars are believed to be correct but their accuracy is not guaranteed and they do not form part of any contract. Whilst every effort is made to ensure the accuracy of these details, it should be noted that the above measurements are approximate only. Floorplans are for representation purposes only and prepared according to the RICS Code of Measuring Practice by our floorplan provider. Therefore, the layout of doors, windows and rooms are approximate should be regarded as such by any prospective purchaser. Any internal photographs are intended as a guide only and it should not be assumed that any of the furniture/fittings are included in any sale. Where shown, details of lease, ground rent and service charge are provided by the vendor and their accuracy cannot be guaranteed, as the information may not have been verified and further checks should be made either through your solicitor/conveyancer or by referring to the home information pack for this property. Where appliances, including central heating, are mentioned, it cannot be assumed that they are in working order, as they have not been tested. Please also note that wiring, plumbing and drains have not been checked.

