



Gloucester Terrace, Bayswater, W2

Kinleigh Folkard & Hayward







**Gloucester Terrace,
Bayswater, W2**
£1,000,000
Shared Freehold

Gloucester Terrace is a picturesque, mostly white stucco fronted and conveniently located avenue, located within a few moments walk of Hyde Park, Paddington Station for the Heathrow Express and Central Line at Lancaster Gate underground.

- 2 bedrooms
- 2 bathrooms (1 en-suite)
- Grand reception room
- Fitted kitchen
- High ceilings
- Shared freehold
- Close to Queensway
- Grade II listed

Boasting a wonderful large west facing reception room with high ceilings, this large well planned flat is for sale on popular Gloucester Terrace, a short walk from Hyde Park.

For more information or to arrange a viewing please contact:

Bayswater
186 Queensway
Bayswater, W2 6LY
020 7724 1222
bayswater.sales@kfh.co.uk

Kinleigh Folkard & Hayward



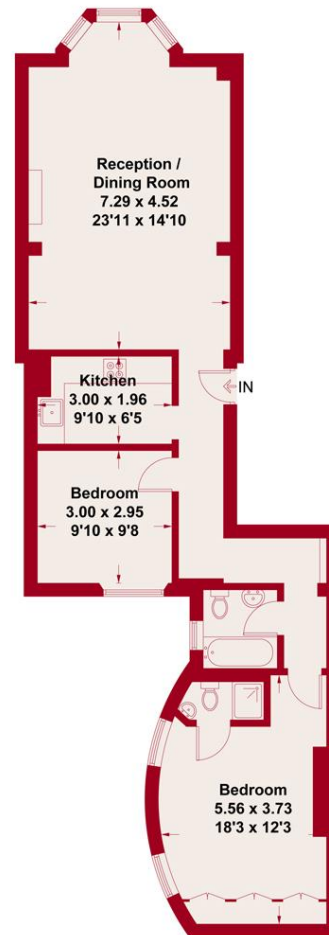

Raised Ground Floor



Gloucester Terrace
Approximate Gross Internal Area = 79.4 sq m / 855 sq ft

Illustration for Identification Purpose Only. Not to Scale.

These particulars are believed to be correct but their accuracy is not guaranteed and they do not form part of any contract. Whilst every effort is made to ensure the accuracy of these details, it should be noted that the above measurements are approximate only. Floorplans are for representation purposes only and prepared according to the RICS Code of Measuring Practice by our floorplan provider. Therefore, the layout of doors, windows and rooms are approximate should be regarded as such by any prospective purchaser. Any internal photographs are intended as a guide only and it should not be assumed that any of the furniture/fittings are included in any sale. Where shown, details of lease, ground rent and service charge are provided by the vendor and their accuracy cannot be guaranteed, as the information may not have been verified and further checks should be made either through your solicitor/conveyancer or by referring to the home information pack for this property. Where appliances, including central heating, are mentioned, it cannot be assumed that they are in working order, as they have not been tested. Please also note that wiring, plumbing and drains have not been checked.

