



Gloucester Terrace, Bayswater, W2

Kinleigh Folkard & Hayward







Gloucester Terrace, Bayswater, W2 £950,000 Shared Freehold

Gloucester Terrace is conveniently located next to the delights of Hyde Park and is within easy reach of the excellent transport links of Paddington and Lancaster Gate.

- Stunning first floor
- High ceilings
- Dark wood flooring
- Stainless steel kitchen
- Two double bedrooms
- Shared freehold
- Grade II listed building

Magnificent ceiling heights, grand proportions and a full width balcony terrace make this stunning first floor apartment a stylish and welcoming home.

For more information or to arrange a viewing please contact:

Bayswater
186 Queensway
Bayswater, W2 6LY
020 7724 1222
bayswater.sales@kfh.co.uk

Kinleigh Folkard & Hayward



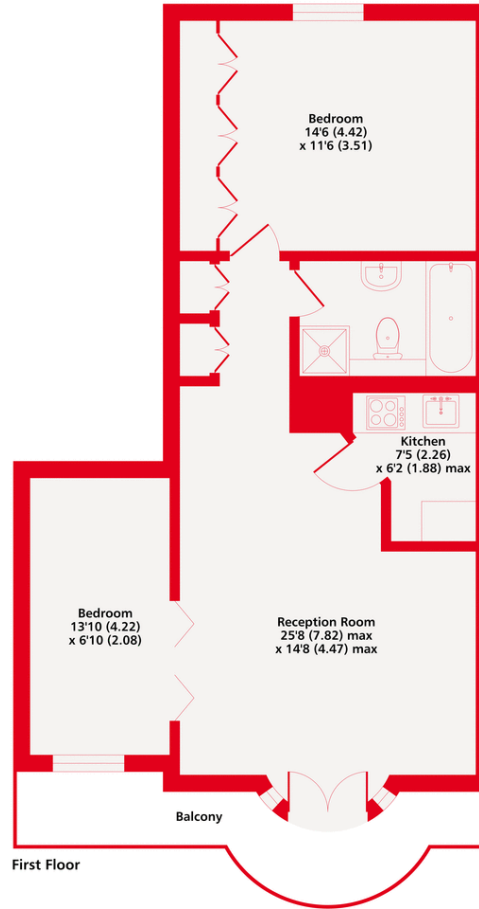

Bayswater, W2
 Approximate Area = 685 sq ft / 63.6 sq m (excludes balcony)
 For identification only - Not to scale

Kinleigh Folkard & Hayward



Floor plan produced in accordance with RICS Property Measurement Standards incorporating International Property Measurement Standards (IPMS2 Residential). © nchecon 2021. Produced for Kinleigh Folkard & Hayward. REF: 759384

These particulars are believed to be correct but their accuracy is not guaranteed and they do not form part of any contract. Whilst every effort is made to ensure the accuracy of these details, it should be noted that the above measurements are approximate only. Floorplans are for representation purposes only and prepared according to the RICS Code of Measuring Practice by our floorplan provider. Therefore, the layout of doors, windows and rooms are approximate should be regarded as such by any prospective purchaser. Any internal photographs are intended as a guide only and it should not be assumed that any of the furniture/fittings are included in any sale. Where shown, details of lease, ground rent and service charge are provided by the vendor and their accuracy cannot be guaranteed, as the information may not have been verified and further checks should be made either through your solicitor/conveyancer or by referring to the home information pack for this property. Where appliances, including central heating, are mentioned, it cannot be assumed that they are in working order, as they have not been tested. Please also note that wiring, plumbing and drains have not been checked.

