



Craven Hill, Bayswater, W2

Kinleigh Folkard & Hayward







Craven Hill, Bayswater, W2 £850,000 Leasehold

Craven Hill Gardens is one of Bayswater's most desirable and attractive terraces and is conveniently located for an easy stroll to The Heathrow Express and Central Line at Paddington and Lancaster Gate stations, as well as the many amenities of Queensway.

- Newly renovated
- 2 Bedrooms
- Bathroom
- Reception room
- Lift
- Leafy views
- Long Lease
- EPC rating E

A modern flat in beautiful condition for sale on leafy and sought after Craven Hill Gardens, sporting wood floors and charming views over gardens. A three minute walk to Hyde Park.

For more information or to arrange a viewing please contact:

Bayswater
186 Queensway
Bayswater, W2 6LY
020 7724 1222
bayswater.sales@kfh.co.uk

Kinleigh Folkard & Hayward



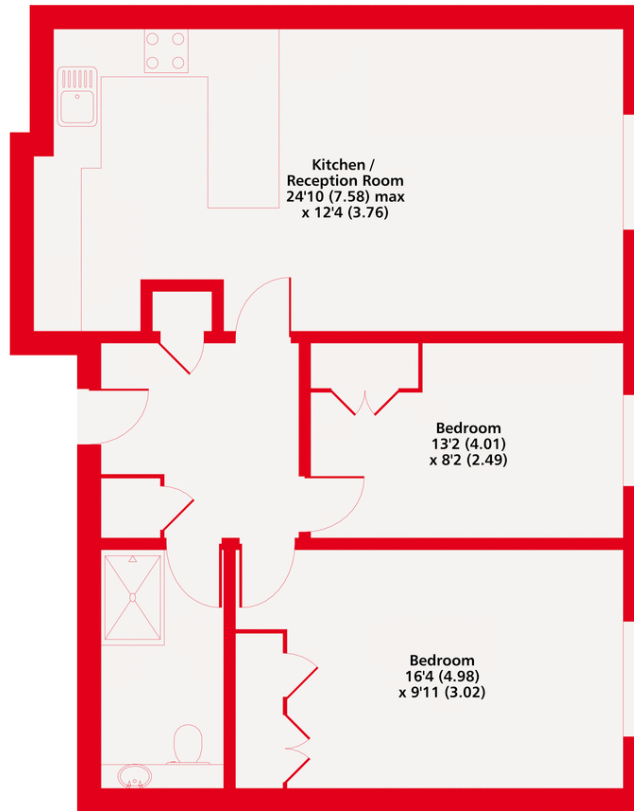

Third Floor

Craven Hill, W2
 Approximate Area = 731 sq ft / 68 sq m
 For identification only - Not to scale

Kinleigh Folkard & Hayward



Floor plan produced in accordance with RICS Property Measurement Standards incorporating International Property Measurement Standards (IPMS2 Residential). © nchecon 2020. Produced for Kinleigh Folkard & Hayward. REF: 630736

These particulars are believed to be correct but their accuracy is not guaranteed and they do not form part of any contract. Whilst every effort is made to ensure the accuracy of these details, it should be noted that the above measurements are approximate only. Floorplans are for representation purposes only and prepared according to the RICS Code of Measuring Practice by our floorplan provider. Therefore, the layout of doors, windows and rooms are approximate should be regarded as such by any prospective purchaser. Any internal photographs are intended as a guide only and it should not be assumed that any of the furniture/fittings are included in any sale. Where shown, details of lease, ground rent and service charge are provided by the vendor and their accuracy cannot be guaranteed, as the information may not have been verified and further checks should be made either through your solicitor/conveyancer or by referring to the home information pack for this property. Where appliances, including central heating, are mentioned, it cannot be assumed that they are in working order, as they have not been tested. Please also note that wiring, plumbing and drains have not been checked.

