



**Verity Close, Holland Park, W11**

**Kinleigh Folkard & Hayward**









**Verity Close,  
Holland Park, W11  
£400,000  
Leasehold**

---

Verity Close is a quiet residential cul-de-sac very close to the transport links of Ladbroke Grove, Latimer Road and Holland Park

- One bedroom
- Modern finish
- Quiet location
- Good transport links
- EPC Rating D

---

**This spacious one bedroom flat is very well proportioned and offers great value for a first time buyer or buy to let investor.**

---

For more information or to arrange a viewing please contact:

**Holland Park**  
128 Holland Park Avenue  
Holland Park, W11 4UE  
0203 542 2111  
hollandpark.sales@kfh.co.uk

---

**Kinleigh Folkard & Hayward**



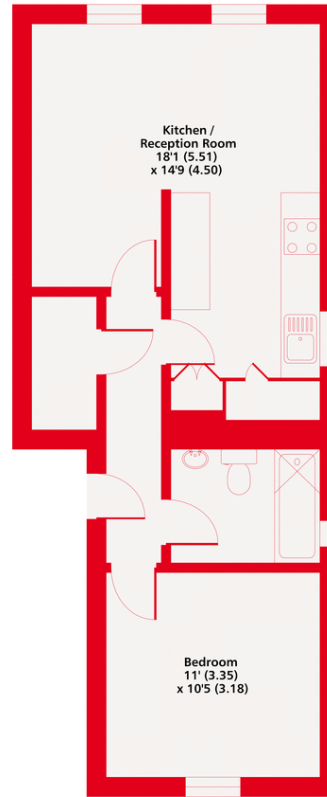

First Floor

Verity Close, W11  
Approximate Area = 503 sq ft / 46.7 sq m  
For identification only - Not to scale

Kinleigh Folkard & Hayward



Floor plan produced in accordance with RICS Property Measurement Standards incorporating International Property Measurement Standards (IPMS2 Residential). © nchecon 2020. Produced for Kinleigh Folkard & Hayward. REF: 640653

These particulars are believed to be correct but their accuracy is not guaranteed and they do not form part of any contract. Whilst every effort is made to ensure the accuracy of these details, it should be noted that the above measurements are approximate only. Floorplans are for representation purposes only and prepared according to the RICS Code of Measuring Practice by our floorplan provider. Therefore, the layout of doors, windows and rooms are approximate should be regarded as such by any prospective purchaser. Any internal photographs are intended as a guide only and it should not be assumed that any of the furniture/fittings are included in any sale. Where shown, details of lease, ground rent and service charge are provided by the vendor and their accuracy cannot be guaranteed, as the information may not have been verified and further checks should be made either through your solicitor/conveyancer or by referring to the home information pack for this property. Where appliances, including central heating, are mentioned, it cannot be assumed that they are in working order, as they have not been tested. Please also note that wiring, plumbing and drains have not been checked.

