



Eastfields Avenue, Wandsworth, SW18

Kinleigh Folkard & Hayward







**Eastfields Avenue,
Wandsworth, SW18**
£620,000
Leasehold

Immaculately presented with a stylish modern finish, residents on site gym and swimming pool, close to the Riverbus service to the city and residents shuttle bus to East Putney tube and Putney train station.

- Luxurious development
- Two bedrooms
- Two private balconies
- Residents gym and pool
- Third floor
- Secure parking
- Concierge
- EPC rating C

A stunning third floor apartment in a luxurious development featuring two double bedrooms, two private balconies, residents pool and gym as well as a concierge.

For more information or to arrange a viewing please contact:

Putney Hill

1 Putney Hill
Putney, SW15 6BA
020 8780 0033
putneyhill.sales@kfh.co.uk

Kinleigh Folkard & Hayward

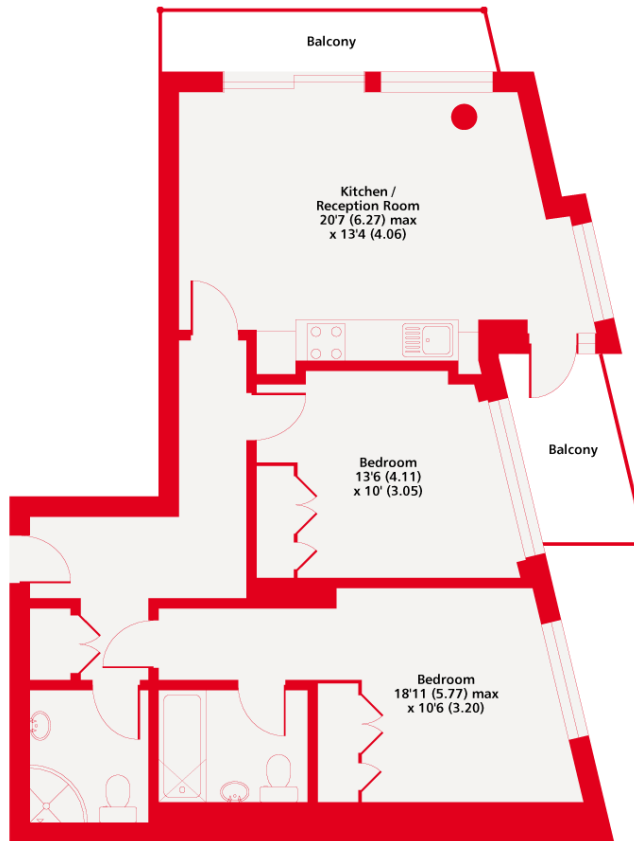

Third Floor

Eastfields Avenue, SW18
 Gross Internal Floor Area 750 sqft 69.6 sqm
 Copyright nichecom.co.uk 2019 REF : 564478

Kinleigh Folkard & Hayward

Whilst every attempt has been made to ensure the accuracy of the floor plan contained here, measurements of doors, windows and rooms are approximate and no responsibility is taken for any error, omission or misstatement. These plans are for representation purposes only as defined by RICS Code of Measuring Practice and should be used as such by any prospective purchaser. Specifically no guarantee is given on the gross internal floor area of the property if quoted on this plan and any figure given is for initial guidance only and should not be relied on as a basis of valuation.
 This floor plan was constructed using measurements provided to Niche Communications by a third party

These particulars are believed to be correct but their accuracy is not guaranteed and they do not form part of any contract. Whilst every effort is made to ensure the accuracy of these details, it should be noted that the above measurements are approximate only. Floorplans are for representation purposes only and prepared according to the RICS Code of Measuring Practice by our floorplan provider. Therefore, the layout of doors, windows and rooms are approximate should be regarded as such by any prospective purchaser. Any internal photographs are intended as a guide only and it should not be assumed that any of the furniture/fittings are included in any sale. Where shown, details of lease, ground rent and service charge are provided by the vendor and their accuracy cannot be guaranteed, as the information may not have been verified and further checks should be made either through your solicitor/conveyancer or by referring to the home information pack for this property. Where appliances, including central heating, are mentioned, it cannot be assumed that they are in working order, as they have not been tested. Please also note that wiring, plumbing and drains have not been checked.

