



Hallfield Estate, Bayswater, W2

Kinleigh Folkard & Hayward







**Hallfield Estate,
Bayswater, W2
£425,000
Leasehold**

The Hallfield Estate is a popular and beautifully located Grade II listed development, set within a brief walk of the many amenities and travel facilities of vibrant Queensway and the green open spaces of stunning Kensington Gardens.



- One double bedroom
- Newly fitted kitchen
- Brand new shower/WC
- Under floor heating
- Minutes from amenities
- 5 mins to Hyde Park
- Chain free
- Grade II listed

A fabulous flat with separate kitchen and bathroom, finished to a very high standard, minutes to all amenities in the heart of Bayswater. Ready to move in, ideal for a FTB or as a BTL.

For more information or to arrange a viewing please contact:

Bayswater
186 Queensway
Bayswater, W2 6LY
020 7724 1222
bayswater.sales@kfh.co.uk

Kinleigh Folkard & Hayward

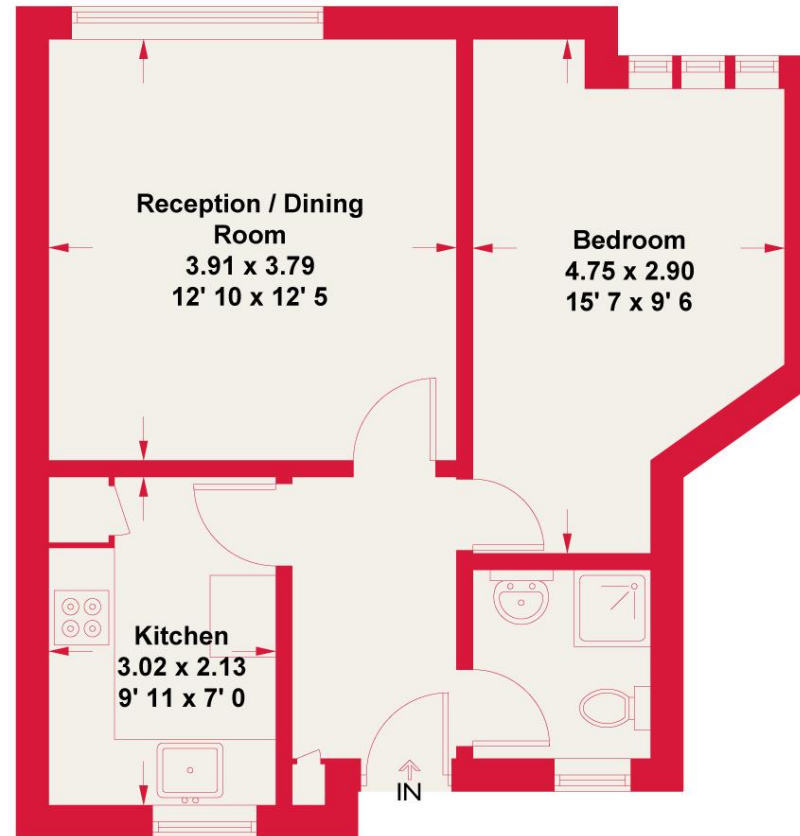

Ground Floor

Marlow House

Approximate Gross Internal Area = 452 sq ft / 42 sq m

Kinleigh Folkard & Hayward

Whilst every attempt has been made to ensure the accuracy of the floor plan contained here, measurements of doors, windows and rooms are approximate and no responsibility is taken for any error, omission or misstatement. These plans are for representation purposes only as defined by RICS Code of Measuring Practice and should be used as such by any prospective purchaser. Specifically no guarantee is given on the gross internal floor area of the property if quoted on this plan and any figure given is initial guidance only and should not be relied on as a basis of valuation.

These particulars are believed to be correct but their accuracy is not guaranteed and they do not form part of any contract. Whilst every effort is made to ensure the accuracy of these details, it should be noted that the above measurements are approximate only. Floorplans are for representation purposes only and prepared according to the RICS Code of Measuring Practice by our floorplan provider. Therefore, the layout of doors, windows and rooms are approximate should be regarded as such by any prospective purchaser. Any internal photographs are intended as a guide only and it should not be assumed that any of the furniture/fittings are included in any sale. Where shown, details of lease, ground rent and service charge are provided by the vendor and their accuracy cannot be guaranteed, as the information may not have been verified and further checks should be made either through your solicitor/conveyancer or by referring to the home information pack for this property. Where appliances, including central heating, are mentioned, it cannot be assumed that they are in working order, as they have not been tested. Please also note that wiring, plumbing and drains have not been checked.

