



*Scott Avenue, Putney, SW15*







**Scott Avenue,  
Putney, SW15**  
**£550,000**  
**Leasehold**

Situated on the fifth floor this property benefits a very attractive view over the communal gardens and is well located with easy access to East Putney or Southfields.

- Two bedrooms
- Openplan living area
- Fifth floor
- Off street parking
- Well presented
- Attractive views
- Residents Gym and library
- Excellent transport links

A beautifully presented apartment located on the top floor of this popular character block. A well proportioned apartment features two bedrooms, open plan living area and off street parking.

For more information or to arrange a viewing please contact:

**Putney Hill**  
1 Putney Hill  
Putney, SW15 6BA  
020 8780 0033  
putneyhill.sales@kfh.co.uk

**Kinleigh Folkard & Hayward**

**kfh.co.uk**



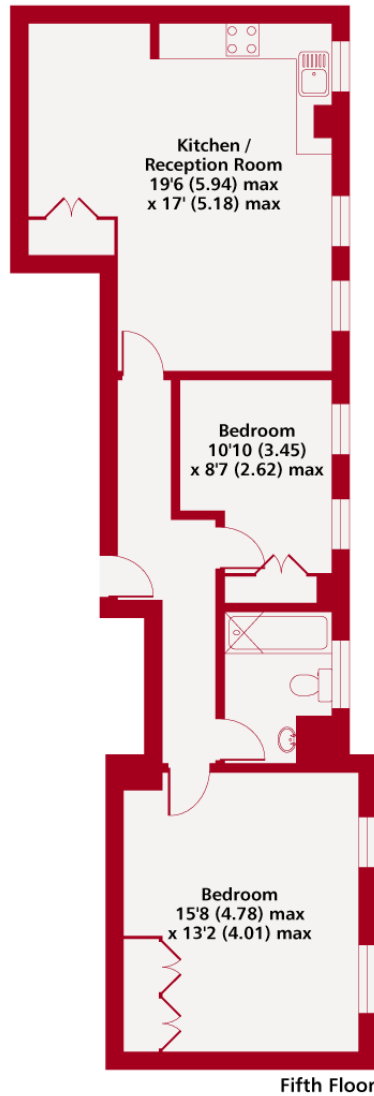

Fifth Floor

Gilbert Scott Building SW15



Gross Internal Floor Area 743 / sqft 69 sqm

Copyright nichecom.co.uk 2018 REF : 276210

Whilst every attempt has been made to ensure the accuracy of the floor plan contained here, measurements of doors, windows and rooms are approximate and no responsibility is taken for any error, omission or misstatement. These plans are for representation purposes only as defined by RICS Code of Measuring Practice and should be used as such by any prospective purchaser. Specifically no guarantee is given on the gross internal floor area of the property if quoted on this plan and any figure given is for initial guidance only and should not be relied on as a basis of valuation.

These particulars are believed to be correct but their accuracy is not guaranteed and they do not form part of any contract. Whilst every effort is made to ensure the accuracy of these details, it should be noted that the above measurements are approximate only. Floorplans are for representation purposes only and prepared according to the RICS Code of Measuring Practice by our floorplan provider. Therefore, the layout of doors, windows and rooms are approximate and should be regarded as such by any prospective purchaser. Any internal photographs are intended as a guide only and it should not be assumed that any of the furniture/fittings are included in any sale. Where shown, details of lease, ground rent and service charge are provided by the vendor and their accuracy cannot be guaranteed, as the information may not have been verified and further checks should be made either through your solicitor/conveyancer or by referring to the home information pack for this property. Where appliances, including central heating, are mentioned, it cannot be assumed that they are in working order, as they have not been tested. Please also note that wiring, plumbing and drains have not been checked.

## Energy Performance Certificate



Gilbert Scott Building,  
Scott Avenue,  
LONDON, SW15

Dwelling type: Top-floor flat  
Date of assessment: 28 April 2009  
Date of certificate: 28 April 2009

Reference number:

Total floor area: 71 m<sup>2</sup>

This home's performance is rated in terms of the energy use per square metre of floor area, energy efficiency based on fuel costs and environmental impact based on carbon dioxide (CO<sub>2</sub>) emissions.

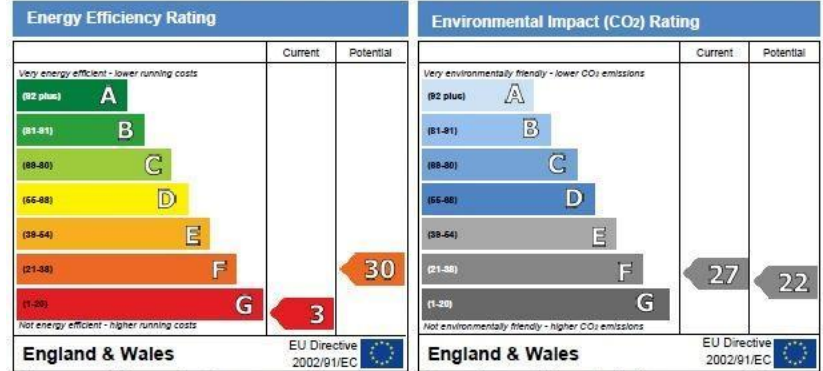

The energy efficiency rating is a measure of the overall efficiency of a home. The higher the rating the more energy efficient the home is and the lower the fuel bills are likely to be.

The environmental impact rating is a measure of this home's impact on the environment in terms of Carbon dioxide (CO<sub>2</sub>) emissions. The higher the rating the less impact it has on the environment.

### Estimated energy use, carbon dioxide (CO<sub>2</sub>) emissions and fuel costs of this home

	Current	Potential
Energy use	713 kWh/m <sup>2</sup> per year	817 kWh/m <sup>2</sup> per year
Carbon dioxide emissions	7.6 tonnes per year	8.7 tonnes per year
Lighting	£52 per year	£52 per year
Heating	£1,879 per year	£897 per year
Hot water	£153 per year	£153 per year

Based on standardised assumptions about occupancy, heating patterns and geographical location, the above table provides an indication of how much it will cost to provide lighting, heating and hot water to this home. The fuel costs only take into account the cost of fuel and not any associated service, maintenance or safety inspection. This certificate has been provided for comparative purposes only and enables one home to be compared with another. Always check the date the certificate was issued, because fuel prices can increase over time and energy saving recommendations will evolve.

To see how this home can achieve its potential rating please see the recommended measures.

The address and energy rating of the dwelling in this EPC may be given to EST to provide information on financial help for improving its energy performance.

For advice on how to take action and to find out about offers available to make your home more energy efficient, call 0800 512 012 or visit [www.energysavingtrust.org.uk/myhome](http://www.energysavingtrust.org.uk/myhome)