



Sunderland Terrace, Bayswater, W2

Kinleigh Folkard & Hayward







Sunderland Terrace, Bayswater, W2 £800,000 Shared Freehold

Sunderland Terrace is a most beautiful and tranquil corner of this popular and fashionable urban location. On the doorstep of the shops and restaurants of trendy Westbourne Grove as well as renowned haunts such as Portobello Road and Notting Hill Gate.

- 2 Bedrooms
- Period conversion
- Prime W2 location
- High ceilings
- Chain free
- Excellent condition
- Share of freehold
- EPC rating C

A stunning example of a classic period conversion. boasting a magnificent open plan reception and kitchen, two generous bedrooms, situated on this leafy Bayswater terrace.

For more information or to arrange a viewing please contact:

Bayswater
186 Queensway
Bayswater, W2 6LY
020 7724 1222
bayswater.sales@kfh.co.uk

Kinleigh Folkard & Hayward

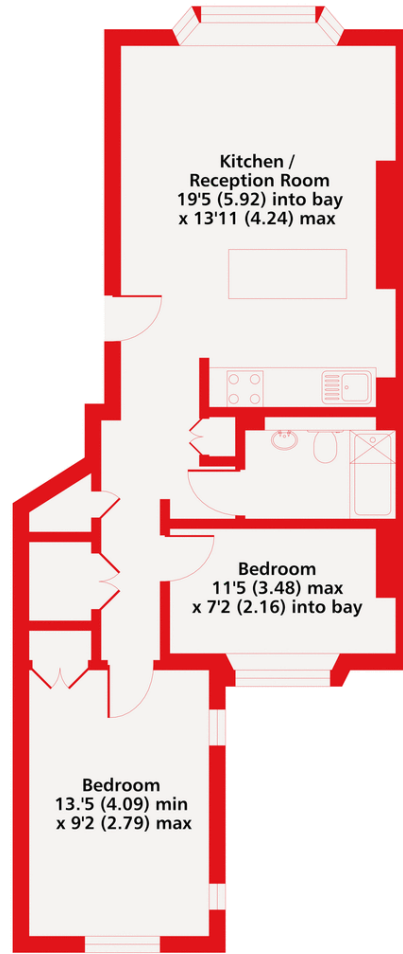

Ground Floor

Sunderland Terrace, W2
 Approximate Area = 618 sq ft / 57.4 sq m
 For identification only - Not to scale

Kinleigh Folkard & Hayward



Floor plan produced in accordance with RICS Property Measurement Standards incorporating International Property Measurement Standards (IPMS2 Residential). © ncheccom 2021. Produced for Kinleigh Folkard & Hayward. REF: 667493

These particulars are believed to be correct but their accuracy is not guaranteed and they do not form part of any contract. Whilst every effort is made to ensure the accuracy of these details, it should be noted that the above measurements are approximate only. Floorplans are for representation purposes only and prepared according to the RICS Code of Measuring Practice by our floorplan provider. Therefore, the layout of doors, windows and rooms are approximate should be regarded as such by any prospective purchaser. Any internal photographs are intended as a guide only and it should not be assumed that any of the furniture/fittings are included in any sale. Where shown, details of lease, ground rent and service charge are provided by the vendor and their accuracy cannot be guaranteed, as the information may not have been verified and further checks should be made either through your solicitor/conveyancer or by referring to the home information pack for this property. Where appliances, including central heating, are mentioned, it cannot be assumed that they are in working order, as they have not been tested. Please also note that wiring, plumbing and drains have not been checked.

